



DIVISIONE VALVOLE

Settore Industriale - Nautico

2016



F.I.M.
Forniture Industriali Meridionali S.r.l.

CONDIZIONI DI VENDITA

Si intendono regolate secondo le normative riportate dal Codice Civile.

Per ogni controversia sarà competente il Foro di Bari.

GARANZIA e ASSICURAZIONE

La garanzia sui nostri prodotti consiste nella sostituzione dell'articolo riconosciuto difettoso.

Non sono coperti da garanzia i prodotti danneggiati per il trasporto, per incapacità d'uso, trascuratezza o manomissioni.

I nostri prodotti sono realizzati con materiali conformi alle normative vigenti e sono assicurati con Polizza Responsabilità Civile dei Prodotti.

La sostituzione dei prodotti deve essere concordata esclusivamente con la nostra Sede.

EVASIONE ORDINI

In linea di massima, gli ordini vengono evasi entro 3/4 giorni dal ricevimento.

Con la merce viene consegnata la fattura accompagnatoria.

CONTESTAZIONI PRODOTTI - TRASPORTI e QUANTITÀ

Eventuali reclami, devono essere comunicati entro e non oltre 8 giorni data di ricevimento merce.

Trascorso tale termine non è più possibile accogliere le contestazioni.

Le fotografie e le confezioni sono da ritenersi indicative.



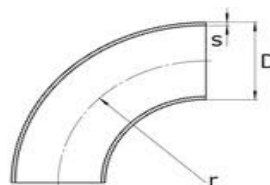

CURVE RICAVATE DA TUBO SALDATO EN 10253-1 D3 90° MATERIALE P235/TR1

CODICE	Ø	D/mm	S	raggio / R	Kg x 90°	nr per conf	PREZZO €
CUD39021	1/2"	21,3	2,0	27,5	0,04	100	
CUD39026	3/4"	26,9	2,3	28,5	0,06	100	
CUD39030		30,0	2,6	33,5	0,08	sfuse	
CUD39033	1"	33,7	2,6	38,0	0,12	100	
CUD39038		38,0	2,6	45,0	0,16	sfuse	
CUD39042	1"1/4	42,4	2,6	47,5	0,19	100	
CUD39044		44,5	2,6	51,0	0,22	sfuse	
CUD39048	1"1/2	48,3	2,6	57,0	0,26	100	
CUD39051		51,0	2,9	63,5	0,31	sfuse	
CUD39054		54,0	2,9	72,0	0,36	sfuse	
CUD39057		57,0	2,9	72,0	0,44	sfuse	
CUD39060	2"	60,3	2,9	76,0	0,49	50	
CUD39063		63,0	2,9	82,5	0,56	sfuse	
CUD39070		70,0	2,9	92,0	0,70	5 pz	
CUD39076	2"1/2	76,1	2,9	95,0	0,78	5 pz	
CUD39082		82,5	3,2	107,5	1,06	4 pz	
CUD39088	3"	88,9	3,2	114,5	1,22	4 pz	
CUD390101	3"1/2	101,6	3,6	133,5	1,83	3 pz	
CUD390108		108,0	3,6	142,5	2,23	3 pz	
CUD390114	4"	114,3	3,6	152,5	2,36	3 pz	
CUD390133		133,0	4,0	181,0	3,64	sfuse	
CUD390139	5"	139,7	4,0	191,0	4,00	sfuse	
CUD390159		159,0	4,5	216,0	5,80	sfuse	
CUD390168	6"	168,3	4,5	228,0	6,50	sfuse	
CUD390193	7"	193,7	5,4	270,0	10,60	sfuse	
CUD390219	8"	219,1	5,9	305,0	15,80	sfuse	
CUD390244		244,0	6,3	340,0	19,80	sfuse	
CUD390273	10"	273,0	6,3	381,0	24,80	sfuse	
CUD390323	12"	323,9	7,1	457,0	36,00	sfuse	
CUD390355	14"	355,6	6,3	534,0	46,00	sfuse	
CUD390406	16"	406,4	6,3	610,0	61,00	sfuse	
CUD390457	18"	457,2	6,3	686,0	77,00	sfuse	
CUD390508	20"	508,0	6,3	762,0	95,00	sfuse	
CUD390609	24"	609,6	6,3	914,0	136,00	sfuse	
CUD390711	28"	711,2	7,1	1067,0	203,00	sfuse	
CUD390812	32"	812,8	8,8	1219,0	300,00	sfuse	

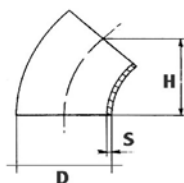

CURVE RICAVATE DA TUBO SALDATO EN 10253-1 D3 45° MATERIALE P235/TR1

CODICE	Ø	D/mm	S	PREZZO €
CUD34560	2"	60,3	2,9	
CUD34576	2"1/2	76,1	2,9	
CUD34588	3"	88,9	3,2	
CUD345101	3"1/2	101,6	3,6	
CUD345108		108,0	3,6	
CUD345114	4"	114,3	3,6	
CUD345133		133,0	4,0	
CUD345139	5"	139,7	4,0	
CUD345159		159,0	4,5	
CUD345168	6"	168,3	4,5	
CUD345193	7"	193,7	5,4	
CUD345219	8"	219,1	5,9	
CUD345244		244,0	6,3	
CUD345273	10"	273,0	6,3	
CUD345323	12"	323,9	7,1	
CUD345355	14"	355,6	6,3	
CUD345406	16"	406,4	6,3	
CUD345457	18"	457,2	6,3	
CUD345508	20"	508,0	6,3	
CUD345609	24"	609,6	6,3	
CUD345711	28"	711,2	7,1	
CUD345812	32"	812,8	8,0	



CURVE RICAVATE DA TUBO SALDATO-EN 10253-1 D3 180° MATERIALE P235/TR1

CODICE	Ø	D/mm	S	PREZZO €
CUD318021	1/2"	21,3	2,0	
CUD318026	3/4"	26,9	2,3	
CUD318033	1"	33,7	2,6	
CUD318042	1"1/4	42,4	2,6	
CUD318048	1"1/2	48,3	2,6	
CUD318051		51,0	2,9	
CUD318054		54,0	2,9	
CUD318057		57,0	2,9	
CUD318060	2"	60,3	2,9	
CUD318070		70,0	2,9	
CUD318076	2"1/2	76,1	2,9	
CUD318088	3"	88,9	3,2	
CUD3180101	3"1/2	101,6	3,6	
CUD3180108		108,0	3,6	
CUD3180114	4"	114,3	3,6	
CUD3180133		133,0	4,0	
CUD3180139	5"	139,7	4,0	
CUD3180159		159,0	4,5	
CUD3180168	6"	168,3	4,5	
CUD3180219	8"	219,1	5,9	



CURVE RICAVATE DA TUBO SALDATO EN 10253-1 D5 90° MATERIALE P235/TR1

CODICE	Ø	D/mm	S	raggio	Kg x 90°	PREZZO €
CUD59026	3/4"	26,9	2,3	57,5	0,11	
CUD59033	1"	33,7	2,6	72,5	0,20	
CUD59042	1"1/4	42,4	2,6	92,5	0,37	
CUD59048	1"1/2	48,3	2,6	108	0,50	
CUD59060	2"	60,3	2,9	135	0,88	
CUD59076	2"1/2	76,1	2,9	175	1,45	
CUD59088	3"	88,9	3,2	205	2,19	
CUD590114	4"	114,3	3,6	270	4,20	



CURVE RICAVATE DA TUBO SALDATO EN 10253-1 D5 180° MATERIALE P235/TR1

CODICE	Ø	D/mm	S		PREZZO €
CUD518026	3/4"	26,9	2,3		
CUD518033	1"	33,7	2,6		
CUD518042	1"1/4	42,4	2,6		
CUD518048	1"1/2	48,3	2,6		
CUD518060	2"	60,3	2,9		
CUD518076	2"1/2	76,1	2,9		
CUD518088	3"	88,9	3,2		
CUD5180114	4"	114,3	3,6		

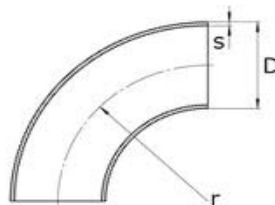

CURVE RICAVATE DA TUBO SENZA SALDATURA EN 10253-1 D3 90° MATERIALE ST 37

CODICE	Ø	D/mm	S	raggio/R		Kg x 90°	nr per conf	PREZZO €
CUD39021SS	1/2"	21,3	2	27,5		0,04	100	
CUD39026SS	3/4"	26,9	2,3	28,5		0,06	100	
CUD39033SS	1"	33,7	2,6	38		0,12	100	
CUD39042SS	1"1/4	42,4	2,6	47,5		0,19	100	
CUD39048SS	1"1/2	48,3	2,6	57		0,26	100	
CUD39060SS	2"	60,3	2,9	76		0,49	50	
CUD39076SS	2"1/2	76,1	2,9	95		0,78	5	
CUD39088SS	3"	88,9	3,2	114,5		1,22	4	
CUD390101SS	3"1/2	101,6	3,6	133,5		1,83	3	
CUD390108SS		108	3,6	142,5		2,23	3	
CUD390114SS	4"	114,3	3,6	152,5		2,36	3	
CUD390133SS		133	4	181		3,64	sfuse	
CUD390139SS	5"	139,7	4	191		4,00	sfuse	
CUD390159SS		159	4,5	216		5,80	sfuse	
CUD390168SS	6"	168,3	4,5	228		6,50	sfuse	
CUD390193SS	7"	193,7	5,4	270		10,60	sfuse	
CUD390219SS	8"	219,1	5,9	305		15,80	sfuse	
CUD390244SS		244	6,3	340		19,80	sfuse	
CUD390273SS	10"	273	6,3	381		24,80	sfuse	
CUD390323SS	12"	323,9	7,1	457		36,00	sfuse	
CUD390355SS	14"	355,6	8	534		46,00	sfuse	
CUD390406SS	16"	406,4	8,8	610		61,00	sfuse	
CUD390457SS	18"	457,2	7,92	686	sch 20	77,00	sfuse	
CUD390508SS	20"	508	9,52	762	sch 20	95,00	sfuse	
CUD390609SS	24"	609,6	9,52	914	sch 20	136,00	sfuse	



CURVE RICAVATE DA TUBO SENZA SALDATURA EN 10253-1 D5 90° MATERIALE ST 37

CODICE	Ø	D/mm	S	raggio		Kg x 90°	nr per conf	PREZZO €
CUD59076SS	2,9	76,1	2,3	175		1,45	sfuse	
CUD59088SS	3,2	88,9	2,6	205		2,23	sfuse	
CUD590114SS	3,6	114,3	2,6	270		4,00	sfuse	
CUD590139SS	4	139,7	2,6	330		7,20	sfuse	
CUD590168SS	4,5	168,3	2,9	390		11,20	sfuse	
CUD590219SS	6,3	219,1	2,9	510		24,90	sfuse	
CUD590273SS	6,3	273	3,2	650		41,50	sfuse	
CUD590323SS	7,1	323,9	3,6	775		67,50	sfuse	

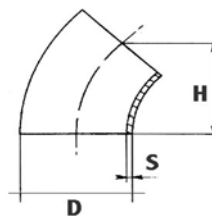

CURVE EN 10253-1 RICAVATE DA TUBO SENZA SALDATURA D3 45° MATERIALE ST 37

CODICE	Ø	D/mm	S		PREZZO €
CUD34560SS	2"	60,3	2,9		
CUD34576SS	2"1/2	76,1	2,9		
CUD34588SS	3"	88,9	3,2		
CUD345101SS	3"1/2	101,6	3,6		
CUD345108SS		108	3,6		
CUD345114SS	4"	114,3	3,6		
CUD345133SS		133	4,0		
CUD345139SS	5"	139,7	4,0		
CUD345159SS		159	4,5		
CUD345168SS	6"	168,3	4,5		
CUD345193SS	7"	193,7	5,4		
CUD345219SS	8"	219,1	5,9		
CUD345244SS		244	6,3		
CUD345273SS	10"	273	6,3		
CUD345323SS	12"	323,9	7,1		
CUD345355SS	14"	355,6	8		
CUD345406SS	16"	406,4	8,8		
CUD345457SS	18"	457,2	7,92	sch 20	
CUD345508SS	20"	508	9,52	sch 20	
CUD345609SS	24"	609,6	9,52	sch 20	

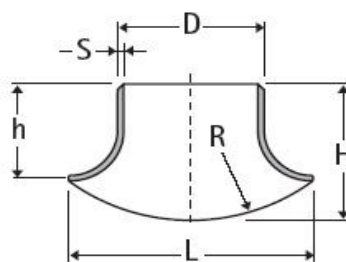

INNESTI A SCARPA EN 10253-1 MATERIALE : TUBI SENZA SALDATURA ST 37

CODICE	Ø	D/mm	S	H	Kg x 90°	PREZZO €
IS33	1"	33,7	2,6	50	0,09	
IS42	1"1/4	42,4	2,6	50	0,15	
IS48	1"1/2	48,3	2,6	64	0,23	
IS60	2"	60,3	2,9	76	0,42	
IS70		70,0	2,9	70	0,38	
IS76	2"1/2	76,1	2,9	88	0,66	
IS88	3"	88,9	3,2	88	0,80	
IS101	3"1/2	101,6	3,6	91	0,90	
IS108		108,0	3,6	97	1,00	
IS114	4"	114,3	3,6	102	1,60	
IS133		133,0	4,0	119	1,90	
IS139	5"	139,7	4,0	125	2,40	
IS159		159,0	4,5	143	2,95	
IS168	6"	168,3	4,5	151	4,30	
IS193		193,7	5,4	174	6,00	
IS219	8"	219,1	5,9	197	7,50	
IS273	10"	273,0	6,3	240	17,50	
IS323	12"	323,9	7,1	275	22,00	

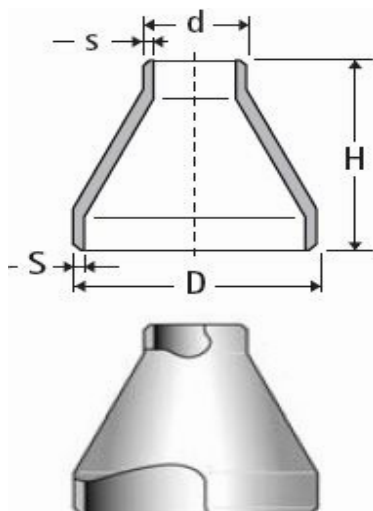

RIDUZIONI CONCENTRICHE EN 10253-1 MATERIALE : TUBI SENZA SALDATURA ST 37

CODICE	D	d	S	s	H	kg	PREZZO €
RC2621	3/4" X	1/2"	2,3	2,0	38	0,08	
RC3321	1" x	1/2"	2,6	2,0	50	0,09	
RC3326	1" x	3/4"	2,6	2,3	50	0,09	
RC4233	1"1/4 x	1"	2,6	2,6	50	0,14	
RC4226	1"1/4 x	3/4"	2,6	2,3	50	0,13	
RC4221	1"1/4 x	1/2"	2,6	2,0	50	0,12	
RC4842	1"1/2 x	1"1/4"	2,6	2,6	64	0,20	
RC4833	1"1/2 x	1"	2,6	2,6	64	0,20	
RC4826	1"1/2 x	3/4"	2,6	2,3	64	0,19	
RC4821	1"1/2 x	1/2"	2,6	2,0	64	0,18	
RC6048	2" x	1"1/2"	2,9	2,6	76	0,33	
RC6042	2" x	1"1/4"	2,9	2,6	76	0,32	
RC6033	2" x	1"	2,9	2,6	76	0,31	
RC6026	2" x	3/4"	2,9	2,3	76	0,30	
RC7660	2"1/2 x	2"	2,9	2,9	90	0,49	
RC7648	2"1/2 x	1"1/2"	2,9	2,6	90	0,48	
RC7642	2"1/2 x	1"1/4"	2,9	2,6	90	0,47	
RC7633	2"1/2 x	1"	2,9	2,6	90	0,40	
RC8876	3" x	2"1/2"	3,2	2,9	90	0,63	
RC8860	3" x	2"	3,2	2,9	90	0,62	
RC8848	3" x	1"1/2"	3,2	2,6	90	0,61	
RC8842	3" x	1"1/4"	3,2	2,6	90	0,55	
RC11488	4" x	3"	3,6	3,2	100	1,02	
RC11476	4" x	2"1/2"	3,6	2,9	100	1,00	
RC11460	4" x	2"	3,6	2,9	100	0,98	
RC11448	4" x	1"1/2"	3,6	2,6	100	0,85	
RC139114	5" x	4"	4,0	3,6	127	1,76	
RC13988	5" x	3"	4,0	3,2	127	1,74	
RC13976	5" x	2"1/2"	4,0	2,9	127	1,70	
RC13960	5" x	2"	4,0	2,9	127	1,60	
RC168139	6" x	5"	4,5	4,0	140	2,94	
RC168114	6" x	4"	4,5	3,6	140	2,82	
RC16888	6" x	3"	4,5	3,2	140	2,70	
RC16876	6" x	2"1/2"	4,5	2,9	140	2,60	
RC219168	8" x	6"	5,9	4,5	152	5,18	
RC219139	8" x	5"	5,9	4,0	152	5,12	
RC219114	8" x	4"	5,9	3,6	152	5,03	
RC273219	10" x	8"	6,3	5,9	178	7,55	
RC273168	10" x	6"	6,3	4,5	178	7,40	
RC273139	10" x	5"	6,3	4,0	178	7,20	
RC273114	10" x	4"	6,3	3,6	178	7,00	
RC323273	12" x	10"	7,1	6,3	203	11,2	
RC323219	12" x	8"	7,1	5,9	203	11,1	
RC323168	12" x	6"	7,1	4,5	203	11,0	

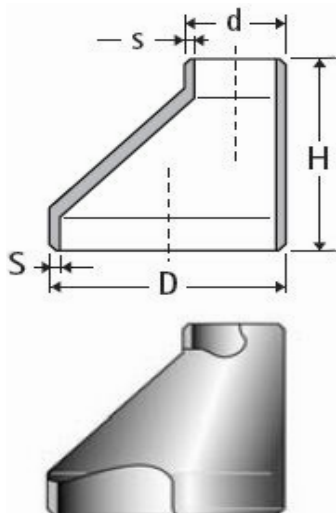

RIDUZIONI ECCENTRICHE EN 10253-1 MATERIALE : TUBI SENZA SALDATURA ST 37

CODICE	D	d	S	s	H	kg	PREZZO €
RE2621	3/4" x	1/2"	2,3	2,0	38	0,08	
RE3321	1" x	1/2"	2,6	2,0	50	0,09	
RE3326	1" x	3/4"	2,6	2,3	50	0,09	
RE4233	1"1/4 x	1"	2,6	2,6	50	0,14	
RE4226	1"1/4 x	3/4"	2,6	2,3	50	0,13	
RE4842	1"1/2 x	1"1/4"	2,6	2,6	64	0,20	
RE4833	1"1/2 x	1"	2,6	2,6	64	0,20	
RE4826	1"1/2 x	3/4"	2,6	2,3	64	0,19	
RE6048	2" x	1"1/2"	2,9	2,6	76	0,33	
RE6042	2" x	1"1/4"	2,9	2,6	76	0,32	
RE6033	2" x	1"	2,9	2,6	76	0,31	
RE6026	2" x	3/4"	2,9	2,3	76	0,30	
RE7660	2"1/2 x	2"	2,9	2,9	90	0,49	
RE7648	2"1/2 x	1"1/2"	2,9	2,6	90	0,48	
RE7642	2"1/2 x	1"1/4"	2,9	2,6	90	0,47	
RE7633	2"1/2 x	1"	2,9	2,6	90	0,40	
RE8876	3" x	2"1/2"	3,2	2,9	90	0,63	
RE8860	3" x	2"	3,2	2,9	90	0,62	
RE8848	3" x	1"1/2"	3,2	2,6	90	0,61	
RE8842	3" x	1"1/4"	3,2	2,6	90	0,55	
RE11488	4" x	3"	3,6	3,2	100	1,02	
RE11476	4" x	2"1/2"	3,6	2,9	100	1,00	
RE11460	4" x	2"	3,6	2,9	100	0,98	
RE11448	4" x	1"1/2"	3,6	2,6	100	0,85	
RE139114	5" x	4"	4,0	3,6	127	1,76	
RE13988	5" x	3"	4,0	3,2	127	1,74	
RE13976	5" x	2"1/2"	4,0	2,9	127	1,70	
RE13960	5" x	2"	4,0	2,9	127	1,60	
RE168139	6" x	5"	4,5	4,0	140	2,94	
RE168114	6" x	4"	4,5	3,6	140	2,82	
RE16888	6" x	3"	4,5	3,2	140	2,70	
RE219168	8" x	6"	5,9	4,5	152	5,18	
RE219139	8" x	5"	5,9	4,0	152	5,12	
RE219114	8" x	4"	5,9	3,6	152	5,03	
RE273219	10" x	8"	6,3	5,9	178	7,55	
RE273168	10" x	6"	6,3	4,5	178	7,40	
RE323273	12" x	10"	7,1	6,3	203	11,20	
RE323219	12" x	8"	7,1	5,9	203	11,10	
RE323168	12" x	6"	7,1	4,5	203	11,00	

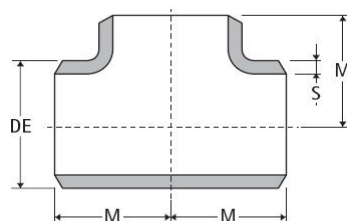

TEE NORMALI EN 10253-1 ISO MATERIALE : WPB ASTM A-234

CODICE	Ø	DE mm	S	M	kg	PREZZO €
TEEN21	1/2"	21,3	2,0	25	0,09	
TEEN26	3/4"	26,9	2,3	29	0,14	
TEEN33	1"	33,7	2,6	38	0,26	
TEEN42	1"1/4	42,2	2,6	48	0,50	
TEEN48	1"1/2	48,3	2,6	57	0,66	
TEEN60	2"	60,3	2,9	64	0,96	
TEEN76	2"1/2	76,1	2,9	76	1,50	
TEEN88	3"	88,9	3,2	86	2,00	
TEEN101	3"1/2	101,6	3,6	95	3,00	
TEEN114	4"	114,3	3,6	105	3,50	
TEEN139	5"	139,7	4,0	124	6,50	
TEEN168	6"	168,3	4,5	143	9,00	
TEEN219	8"	219,1	6,3	178	18,00	
TEEN273	10"	273,0	6,3	216	26,50	
TEEN323	12"	323,8	7,1	254	42,00	

FONDI BOMBATI MATERIALE : S 235

CODICE	Ø	OD/mm	H	S	kg	PREZZO €
FO21	1/2"	21,3	11	2,0	0,011	
FO26	3/4"	26,9	11	2,3	0,017	
FO33	1"	33,7	15	2,3	0,030	
FO42	1"1/4	42,4	18	2,6	0,045	
FO48	1"1/2	48,3	18	2,6	0,058	
FO51		51,0		2,9	0,10	
FO57		57,0		2,9	0,10	
FO60	2"	60,3	22	2,9	0,10	
FO76	2"1/2	76,1	25	2,9	0,14	
FO88	3"	88,9	27	3,2	0,22	
FO101	3"1/2	101,6	30	3,2	0,33	
FO108		108,0	34	3,2	0,42	
FO114	4"	114,3	34	3,2	0,42	
FO121		121,0		3,6	0,40	
FO133		133,0	36	3,6	0,43	
FO139	5"	139,7	39	4,0	0,65	
FO159		159,0	41	4,0	0,90	
FO168	6"	168,3	43	4,0	1,00	
FO193	193	193,7	50	4,0	1,30	
FO219	8"	219,1	55	4,0	1,70	
FO244		244,0			2,20	
FO273	10"	273,0	57	4,0	2,50	
FO323	12"	323,9	60	4,0	3,40	
FO355	14"	355,6	73	5,0	5,35	
FO406	16"	406,4	84	5,0	6,95	
FO457	18"	457,2	123	6,0		
FO508	20"	508,0	105	6,0	13,30	
FO609	24"	609,6	150	6,0	20,20	

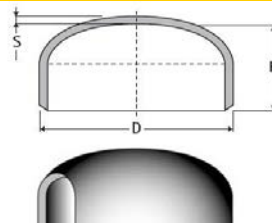

MANICOTTI NERI EN 10241**MATERIALE : TUBO SALDATO ST37**

CODICE	Ø	lung/mm	D.est. mm	PREZZO €
MANE1/8	1/8"	17	15,0	
MANE1/4	1/4"	25	18,5	
MANE17	3/8"	26	21,3	
MANE21	1/2"	34	26,6	
MANE26	3/4"	36	31,8	
MANE33	1"	43	39,5	
MANE42	1"1/4	48	48,3	
MANE48	1"1/2	48	54,5	
MANE60	2"	56	66,3	
MANE76	2"1/2	65	82,0	
MANE88	3"	71	95,0	
MANE114	4"	83	122,0	
MANE139	5"	92	147,0	
MANE168	6"	92	174,0	

**MANICOTTI ZINCATI EN 10241****MATERIALE : TUBO SALDATO ST37**

CODICE	Ø	lung/mm	D.est. mm	PREZZO €
MAZN1/8	1/8"	17	15,0	
MAZN1/4	1/4"	25	18,5	
MAZN17	3/8"	26	21,3	
MAZN21	1/2"	34	26,6	
MAZN26	3/4"	36	31,8	
MAZN33	1"	43	39,5	
MAZN42	1"1/4	48	48,3	
MAZN48	1"1/2	48	54,5	
MAZN60	2"	56	66,3	
MAZN76	2"1/2	65	82,0	
MAZN88	3"	71	95,0	
MAZN114	4"	83	122,0	

**MEZZI MANICOTTI NERI EN 10241****MATERIALE : TUBO SALDATO ST37**

CODICE	Ø	lung/mm	D.est. mm	PREZZO €
MM21	1/2"	15	26,6	
MM26	3/4"	17	31,8	
MM33	1"	20	39,5	
MM42	1"1/4	22	48,3	
MM48	1"1/2	22	54,5	
MM60	2"	26	66,3	
MM76	2"1/2	30	82	
MM88	3"	33	95	



**TRONCHETTI NERI FILETTATURA GAS****MATERIALE : TUBO SALDATO P 235**

CODICE	Ø	L	PREZZO €
TR1760	3/8"	60	
TR1780	3/8"	80	
TR17100	3/8"	100	
TR17120	3/8"	120	
TR17150	3/8"	150	
TR17200	3/8"	200	
TR17250	3/8"	250	
TR17300	3/8"	300	
TR17500	3/8"	500	
TR2160	1/2"	60	
TR2180	1/2"	80	
TR21100	1/2"	100	
TR21120	1/2"	120	
TR21150	1/2"	150	
TR21200	1/2"	200	
TR21250	1/2"	250	
TR21300	1/2"	300	
TR21500	1/2"	500	
TR2660	3/4"	60	
TR2680	3/4"	80	
TR26100	3/4"	100	
TR26120	3/4"	120	
TR26150	3/4"	150	
TR26200	3/4"	200	
TR26250	3/4"	250	
TR26300	3/4"	300	
TR26500	3/4"	500	
TR3360	1"	60	
TR3380	1"	80	
TR33100	1"	100	
TR33120	1"	120	
TR33150	1"	150	
TR33200	1"	200	
TR33250	1"	250	
TR33300	1"	300	
TR33500	1"	500	
TR4260	1"1/4	60	
TR4280	1"1/4	80	
TR42100	1"1/4	100	
TR42120	1"1/4	120	
TR42150	1"1/4	150	
TR42200	1"1/4	200	
TR42250	1"1/4	250	
TR42300	1"1/4	300	
TR42500	1"1/4	500	

**TRONCHETTI NERI FILETTATURA GAS****MATERIALE : TUBO SALDATO P 235**

CODICE	Ø	L	PREZZO €
TR4860	1"1/2	60	
TR4880	1"1/2	80	
TR48100	1"1/2	100	
TR48120	1"1/2	120	
TR48150	1"1/2	150	
TR48200	1"1/2	200	
TR48250	1"1/2	250	
TR48300	1"1/2	300	
TR48500	1"1/2	500	
TR6060	2"	60	
TR6080	2"	80	
TR60100	2"	100	
TR60120	2"	120	
TR60150	2"	150	
TR60200	2"	200	
TR60250	2"	250	
TR60300	2"	300	
TR60500	2"	500	
TR7680	2"1/2	80	
TR76100	2"1/2	100	
TR76120	2"1/2	120	
TR76150	2"1/2	150	
TR176200	2"1/2	200	
TR76250	2"1/2	250	
TR76300	2"1/2	300	
TR76500	2"1/2	500	
TR8880	3"	80	
TR88100	3"	100	
TR88120	3"	120	
TR88150	3"	150	
TR88200	3"	200	
TR88250	3"	250	
TR88300	3"	300	
TR88500	3"	500	
TR10180	3"1/2	80	
TR101100	3"1/2	100	
TR101120	3"1/2	120	
TR101150	3"1/2	150	
TR101200	3"1/2	200	
TR101250	3"1/2	250	
TR101300	3"1/2	300	
TR101500	3"1/2	500	
TR11480	4"	80	
TR114100	4"	100	
TR114120	4"	120	
TR114150	4"	150	
TR114200	4"	200	
TR114250	4"	250	
TR114300	4"	300	
TR114500	4"	500	
TR139150	5"	150	
TR168150	6"	150	



BARILOTTI NERI E ZINCATI FILETTATURA GAS MATERIALE : TUBO SALDATO P 235

CODICE NERO	Ø	L	PREZZO €	CODICE ZINCATO	Ø	L	PREZZO €
BN1760	3/8"	60		BZ1760	3/8"	60	
BN1780	3/8"	80		BZ1780	3/8"	80	
BN17100	3/8"	100		BZ17100	3/8"	100	
BN17120	3/8"	120		BZ17120	3/8"	120	
BN17150	3/8"	150		BZ17150	3/8"	150	
BN17200	3/8"	200		BZ17200	3/8"	200	
BN17250	3/8"	250		BZ17250	3/8"	250	
BN17300	3/8"	300		BZ17300	3/8"	300	
BN17500	3/8"	500		BZ17500	3/8"	500	
BN17700	3/8"	700		BZ17700	3/8"	700	
BN171000	3/8"	1000		BZ171000	3/8"	1000	
BN171500	3/8"	1500		BZ171500	3/8"	1500	
BN172000	3/8"	2000		BZ172000	3/8"	2000	
BN2160	1/2"	60		BZ2160	1/2"	60	
BN2180	1/2"	80		BZ2180	1/2"	80	
BN21100	1/2"	100		BZ21100	1/2"	100	
BN21120	1/2"	120		BZ21120	1/2"	120	
BN21150	1/2"	150		BZ21150	1/2"	150	
BN21200	1/2"	200		BZ21200	1/2"	200	
BN21250	1/2"	250		BZ21250	1/2"	250	
BN21300	1/2"	300		BZ21300	1/2"	300	
BN21500	1/2"	500		BZ21500	1/2"	500	
BN21700	1/2"	700		BZ21700	1/2"	700	
BN211000	1/2"	1000		BZ211000	1/2"	1000	
BN211500	1/2"	1500		BZ211500	1/2"	1500	
BN212000	1/2"	2000		BZ212000	1/2"	2000	
BN2660	3/4"	60		BZ2660	3/4"	60	
BN2680	3/4"	80		BZ2680	3/4"	80	
BN26100	3/4"	100		BZ26100	3/4"	100	
BN26120	3/4"	120		BZ26120	3/4"	120	
BN26150	3/4"	150		BZ26150	3/4"	150	
BN26200	3/4"	200		BZ26200	3/4"	200	
BN26250	3/4"	250		BZ26250	3/4"	250	
BN26300	3/4"	300		BZ26300	3/4"	300	
BN26500	3/4"	500		BZ26500	3/4"	500	
BN26700	3/4"	700		BZ26700	3/4"	700	
BN261000	3/4"	1000		BZ261000	3/4"	1000	
BN261500	3/4"	1500		BZ261500	3/4"	1500	
BN262000	3/4"	2000		BZ262000	3/4"	2000	
BN3360	1"	60		BZ3360	1"	60	
BN3380	1"	80		BZ3380	1"	80	
BN33100	1"	100		BZ33100	1"	100	
BN33120	1"	120		BZ33120	1"	120	
BN33150	1"	150		BZ33150	1"	150	
BN33200	1"	200		BZ33200	1"	200	
BN33250	1"	250		BZ33250	1"	250	
BN33300	1"	300		BZ33300	1"	300	
BN33500	1"	500		BZ33500	1"	500	
BN33700	1"	700		BZ33700	1"	700	
BN331000	1"	1000		BZ331000	1"	1000	
BN331500	1"	1500		BZ331500	1"	1500	
BN332000	1"	2000		BZ332000	1"	2000	



BARILOTTI NERI E ZINCATI FILETTATURA GAS MATERIALE : TUBO SALDATO P 235

CODICE NERO	Ø	L	PREZZO €	CODICE ZINCATO	Ø	L	PREZZO €
BN4260	1"1/4	60		BZ4260	1"1/4	60	
BN4280	1"1/4	80		BZ4280	1"1/4	80	
BN42100	1"1/4	100		BZ42100	1"1/4	100	
BN42120	1"1/4	120		BZ42120	1"1/4	120	
BN42150	1"1/4	150		BZ42150	1"1/4	150	
BN42200	1"1/4	200		BZ42200	1"1/4	200	
BN42250	1"1/4	250		BZ42250	1"1/4	250	
BN42300	1"1/4	300		BZ42300	1"1/4	300	
BN42500	1"1/4	500		BZ42500	1"1/4	500	
BN42700	1"1/4	700		BZ42700	1"1/4	700	
BN421000	1"1/4	1000		BZ421000	1"1/4	1000	
BN421500	1"1/4	1500		BZ421500	1"1/4	1500	
BN422000	1"1/4	2000		BZ422000	1"1/4	2000	
BN4860	1"1/2	60		BZ4860	1"1/2	60	
BN4880	1"1/2	80		BZ4880	1"1/2	80	
BN48100	1"1/2	100		BZ48100	1"1/2	100	
BN48120	1"1/2	120		BZ48120	1"1/2	120	
BN48150	1"1/2	150		BZ48150	1"1/2	150	
BN48200	1"1/2	200		BZ48200	1"1/2	200	
BN48250	1"1/2	250		BZ48250	1"1/2	250	
BN48300	1"1/2	300		BZ48300	1"1/2	300	
BN48500	1"1/2	500		BZ48500	1"1/2	500	
BN48700	1"1/2	700		BZ48700	1"1/2	700	
BN481000	1"1/2	1000		BZ481000	1"1/2	1000	
BN481500	1"1/2	1500		BZ481500	1"1/2	1500	
BN482000	1"1/2	2000		BZ482000	1"1/2	2000	
BN6080	2"	80		BZ6080	2"	80	
BN60100	2"	100		BZ60100	2"	100	
BN60120	2"	120		BZ60120	2"	120	
BN60150	2"	150		BZ60150	2"	150	
BN60200	2"	200		BZ60200	2"	200	
BN60250	2"	250		BZ60250	2"	250	
BN60300	2"	300		BZ60300	2"	300	
BN60500	2"	500		BZ60500	2"	500	
BN60700	2"	700		BZ60700	2"	700	
BN601000	2"	1000		BZ601000	2"	1000	
BN601500	2"	1500		BZ601500	2"	1500	
BN602000	2"	2000		BZ602000	2"	2000	
BN7680	2"1/2	80		BZ7680	2"1/2	80	
BN76100	2"1/2	100		BZ76100	2"1/2	100	
BN76120	2"1/2	120		BZ76120	2"1/2	120	
BN76150	2"1/2	150		BZ76150	2"1/2	150	
BN76200	2"1/2	200		BZ76200	2"1/2	200	
BN76250	2"1/2	250		BZ76250	2"1/2	250	
BN76300	2"1/2	300		BZ76300	2"1/2	300	
BN76500	2"1/2	500		BZ76500	2"1/2	500	
BN76700	2"1/2	700		BZ76700	2"1/2	700	
BN761000	2"1/2	1000		BZ761000	2"1/2	1000	
BN761500	2"1/2	1500		BZ761500	2"1/2	1500	
BN762000	2"1/2	2000		BZ762000	2"1/2	2000	



BARILOTTI NERI E ZINCATI FILETTATURA GAS MATERIALE : TUBO SALDATO P 235

CODICE NERO	Ø	L	PREZZO €	CODICE ZINCATO	Ø	L	PREZZO €
BN8880	3"	80		BZ8880	3"	80	
BN88100	3"	100		BZ88100	3"	100	
BN88120	3"	120		BZ88120	3"	120	
BN88150	3"	150		BZ88150	3"	150	
BN88200	3"	200		BZ88200	3"	200	
BN88250	3"	250		BZ88250	3"	250	
BN88300	3"	300		BZ88300	3"	300	
BN88500	3"	500		BZ88500	3"	500	
BN881000	3"	1000		BZ881000	3"	1000	
BN881500	3"	1500		BZ881500	3"	1500	
BN882000	3"	2000		BZ882000	3"	2000	
BN10180	3"1/2	80		BZ10180	3"1/2	80	
BN101100	3"1/2	100		BZ101100	3"1/2	100	
BN101120	3"1/2	120		BZ101120	3"1/2	120	
BN101150	3"1/2	150		BZ101150	3"1/2	150	
BN101200	3"1/2	200		BZ101200	3"1/2	200	
BN101250	3"1/2	250		BZ101250	3"1/2	250	
BN101300	3"1/2	300		BZ101300	3"1/2	300	
BN11480	4"	80		BZ11480	4"	80	
BN114100	4"	100		BZ114100	4"	100	
BN114120	4"	120		BZ114120	4"	120	
BN114150	4"	150		BZ114150	4"	150	
BN114200	4"	200		BZ114200	4"	200	
BN114250	4"	250		BZ114250	4"	250	
BN114300	4"	300		BZ114300	4"	300	
BN114500	4"	500		BZ114500	4"	500	
BN114700	4"	700		BZ114700	4"	700	
BN1141000	4"	1000		BZ1141000	4"	1000	
BN1141500	4"	1500		BZ1141500	4"	1500	
BN1142000	4"	2000		BZ1142000	4"	2000	
BN139150	5"	150		BZ139150	5"	150	
BN168150	6"	150		BZ168150	6"	150	

FLANGE PIANE EN 1092-1 A PN 6

CODICE	DN	D	d1	f	b	a	n.fori	KG	PREZZO €
227615	15	80	22,0	11	12	55	4	0,40	
227620	20	90	27,5	11	14	65	4	0,59	
227625	25	100	34,5	11	14	75	4	0,72	
227632	32	120	43,5	14	16	90	4	1,16	
227640	40	130	49,5	14	16	100	4	1,35	
227650	50	140	61,5	14	16	110	4	1,48	
227665	65	160	77,7	14	16	130	4	1,86	
227680	80	190	90,5	18	18	150	4	2,95	
2276100	100	210	116,0	18	18	170	4	3,26	
2276125	125	240	141,5	18	20	200	8	4,31	
2276150	150	265	170,5	18	20	225	8	4,75	
2276200	200	320	221,5	18	22	280	8	6,88	
2276250	250	375	275,5	18	24	335	12	8,92	
2276300	300	440	327,5	22	24	395	12	11,92	
2276350	350	490	359,5	22	26	445	12	16,84	
2276400	400	540	411,0	22	28	495	16	19,84	
2276450	450	595	462,0	22	30	550	16	24,57	
2276500	500	645	513,5	22	30	600	20	26,39	
2276600	600	755	616,5	26	32*	705	20	34,81	
2276700	700	860	714,2	26	32*	810	24	42,08	UNI
2276800	800	975	815,8	30	34*	920	24	55,23	UNI
2276900	900	1075	917,4	30	36*	1020	24	64,90	UNI
22761000	1000	1175	1019	30	36*	1120	28	69,92	UNI

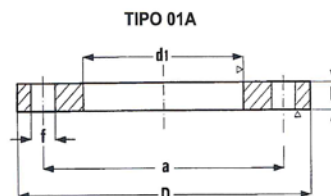

FLANGE PIANE EN 1092-1 A PN 10

CODICE	DN	D	d1	f	b	a	n.fori	KG	PREZZO €
227780	80	200	90,5	18	20	160	8	3,61	
2277200	200	340	221,5	22	24	295	8	9,27	
2277250	250	395	276,5	22	26	350	12	11,82	
2277300	300	445	327,5	22	26	400	12	13,62	
2277350	350	505	359,5	22	28	460	16	20,38	
2277400	400	565	411,0	26	32	515	16	27,52	
2277450	450	615	462,0	26	36	565	20	33,57	
2277500	500	670	513,5	26	38	620	20	40,22	
2277600	600	780	616,5	30	42	725	20	54,46	
2277700	700	895	714,2	30	38*	840	24	62,50	UNI
2277800	800	1015	815,8	33	40*	950	24	83,01	UNI
2277900	900	1115	917,4	33	42*	1050	28	95,81	UNI
22771000	1000	1230	1019	36	44*	1160	28	118,33	UNI

FLANGE PIANE EN 1092-1 A PN 16

CODICE	DN	D	d1	f	b	a	n.fori	KG	PREZZO €
227815	15	95	22	14	14	65	4	0,67	
227820	20	105	27,5	14	16	75	4	0,94	
227825	25	115	34,5	14	16	85	4	1,11	
227832	32	140	43,5	18	18	100	4	1,82	
227840	40	150	49,5	18	18	110	4	2,08	
227850	50	165	61,5	18	19	125	4	2,59	
227865	65	185	77,5	18	20	145	4/8	3,32	
227880	80	200	90,5	18	20	160	8	3,60	
2278100	100	220	116,5	18	22	180	8	4,39	
2278125	125	250	141,5	18	22	210	8	5,41	
2278150	150	285	170,5	22	24	240	8	7,14	
2278200	200	340	221,5	22	26	295	12	9,73	
2278250	250	405	276,5	26	29	355	12	14,21	
2278300	300	460	327,5	26	32	410	12	18,99	

FLANGE PIANE EN 1092-1 A PN 16

CODICE	DN	D	d1	f	b	a	n.fori	KG	PREZZO €
2278350	350	520	359,5	26	35	470	16	28,13	
2278400	400	580	411,0	30	38	525	16	35,86	
2278450	450	640	462,0	30	42	585	20	46,13	
2278500	500	715	513,5	33	46	650	20	64,00	
2278600	600	840	616,5	36	52	770	20	96,05	
2278700	700	910	714,2	36	46	840	24	80,64	UNI
2278800	800	1025	815,8	39	46	950	24	102,58	UNI
2278900	900	1125	917,4	39	50	1050	28	117,57	UNI
22781000	1000	1255	1019	42	50	1170	28	149,58	UNI

FLANGE PIANE EN 1092-1 B PN 16

CODICE	DN	D	d1	f	b	a	n.fori	KG	PREZZO €
2278/2915	15	95	22	14	14	65	4	0,50	
2278/2920	20	105	27,5	14	16	75	4	1,00	
2278/2925	25	115	34,5	14	16	85	4	1,00	
2278/2932	32	14	43,5	18	18	100	4	2,00	
2278/2940	40	150	49,5	18	18	110	4	2,00	
2278/2950	50	165	61,5	18	19	125	4	2,59	
2278/2965	65	185	77,5	18	20	145	8	3,32	
2278/2980	80	200	90,5	18	20	160	8	3,60	
2278/29100	100	220	116,5	18	22	180	8	4,39	
2278/29125	125	250	141,5	18	22	210	8	5,41	
2278/29150	150	285	170,5	22	24	240	8	7,14	
2278/29200	200	340	221,5	22	26	295	12	9,73	
2278/29250	250	405	276,5	26	29	355	12	14,21	
2278/29300	300	460	327,5	26	32	410	12	18,99	

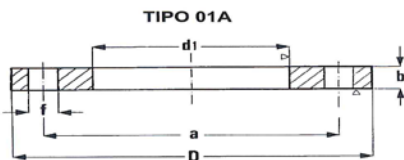

FLANGE PIANE EN 1092-1 A PN 25

CODICE	DN	D	d1	f	b	a	n.fori	kg	PREZZO €
6083200	200	360	221,5	26	32	310	12	14,5	
6083250	250	425	276,5	30	35	370	12	20,0	
6083300	300	485	327,5	30	38	430	16	26,5	
6083350	350	555	359,5	33	42	490	16	42,0	
6083400	400	620	411	36	46	550	16	55,0	

FLANGE PIANE EN 1092-1 A PN 40

CODICE	DN	D	d1	f	b	a	n.fori	kg	PREZZO €
608450	50	165	61,5	18	20	125	4	2,73	
608465	65	185	77,5	18	22	145	8	3,48	
608480	80	200	90,5	18	24	160	8	4,32	
6084100	100	235	116,5	22	26	190	8	6,07	
6084125	125	270	141,5	26	28	220	8	8,19	
6084150	150	300	170,5	26	30	250	8	10,27	
6084200	200	375	221,5	30	36	320	12	17,93	
6084250	250	450	276,5	33	44	385	12	29,25	
6084300	300	515	327,5	33	48	450	16	41,59	
6084350	350	580	359,5	36	54	510	16	62,06	
6084400	400	660	411	39	60	585	16	89,65	

FLANGE LIBERE EN 1092-2 A PN 10

CODICE	DN	D	d2	f	b	a	n.fori	Kg	PREZZO €
6089200	200	340	226	22	24	295	8	8,97	
6089250	250	395	281	22	26	350	12	11,42	
6089300	300	445	333	22	26	400	12	13,04	

FLANGE LIBERE EN 1092-2 A PN 16

CODICE	DN	D	d2	f	b	a	n.fori	Kg	PREZZO €
609015	15	95	25	14	14	65	4	0,66	
609020	20	105	31	14	16	75	4	0,91	
609025	25	115	38	14	16	85	4	1,07	
609032	32	140	47	18	18	100	4	1,79	
609040	40	150	53	18	18	110	4	2,03	
609050	50	165	65	18	19	125	4	2,52	
609065	65	185	81	18	20	145	8	3,12	
609080	80	200	94	18	20	160	8	4,42	
6090100	100	220	120	18	22	180	8	4,15	
6090125	125	250	145	18	22	210	8	5,10	
6090150	150	285	174	22	24	240	8	6,87	
6090200	200	340	226	22	26	295	12	9,27	
6090250	250	405	281	26	29	355	12	13,79	
6090300	300	460	333	26	32	410	12	18,23	

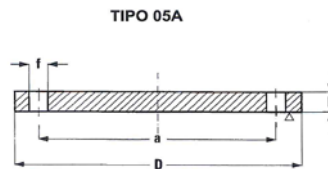

FLANGE CIECA EN 1092-05 A PN 6

CODICE	DN	D	a	f	b	n.fori	KG	PREZZO €
609125	25	100	75	11	14	4	0,82	
609132	32	120	90	14	14	4	1,17	
609140	40	130	100	14	14	4	1,39	
609150	50	140	110	14	14	4	1,62	
609165	65	160	130	14	14	4	2,14	
609180	80	190	150	18	16	4	3,43	
6091100	100	210	170	18	16	4	4,22	
6091125	125	240	200	18	18	8	6,11	
6091150	150	265	225	18	18	8	7,51	
6091200	200	320	280	18	20	8	12,30	
6091250	250	375	335	18	22	12	18,50	
6091300	300	440	395	22	22	12	25,50	
6091350	350	490	445	22	22	12	31,80	
6091400	400	540	495	22	22	16	38,50	
6091450	450	595	550	22	22	16	51,00	
6091500	500	645	600	22	24	20	60,40	
6091600	600	755	705	26	30	20	116,65	
6091700	700	860	810	26	28	24	144,16	UNI
6091800	800	975	920	30	28	24	198,09	UNI
6091900	900	1075	1020	30	30	24	239,26	UNI
60911000	1000	1175	1120	30	30	28	309,52	UNI

FLANGE CIECA EN 1092-05 A PN 10

CODICE	DN	D	a	f	b	n.fori	KG	PREZZO €
609280	80	200	160	18	20	4	4,61	
6092200	200	340	295	22	24	8	16,50	
6092250	250	395	350	22	24	12	24,10	
6092300	300	445	400	22	26	12	30,80	
6092350	350	505	460	22	26	16	39,60	
6092400	400	565	515	26	26	16	49,60	
6092450	450	615	565	26	28	20	63,00	
6092500	500	670	620	26	28	20	75,16	
6092600	600	780	725	30	34	20	123,76	
6092700	700	895	840	30	30	24	144,16	UNI
6092800	800	1015	950	33	32	24	260,00	UNI
6092900	900	1115	1050	33	32	28	344,00	UNI
60921000	1000	1230	1160	36	34	28	473,50	UNI



TIPO 05A

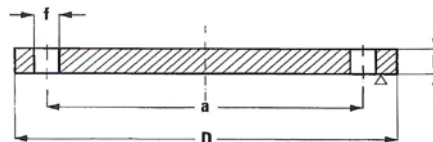

FLANGE CIECA EN 1092-05 A PN 16

CODICE	DN	D	a	f	b	n.fori	kg	PREZZO €
609315	15	95	65	14	16	4	0,71	
609320	20	105	75	14	18	4	1,01	
609325	25	115	85	14	18	4	1,22	
609332	32	140	100	18	18	4	1,80	
609340	40	150	110	18	18	4	2,09	
609350	50	165	125	18	18	4	2,87	
609365	65	185	145	18	18	8	3,65	
609380	80	200	160	18	20	8	4,61	
6093100	100	220	180	18	20	8	5,65	
6093125	125	250	210	18	22	8	8,12	
6093150	150	285	240	22	22	8	10,50	
6093200	200	340	295	22	24	12	16,50	
6093250	250	405	355	26	26	12	25,10	
6093300	300	460	410	26	28	12	35,20	
6093350	350	520	470	26	30	16	48,20	
6093400	400	580	525	30	32	16	63,50	
6093450	450	640	585	30	40	20	96,50	
6093500	500	715	650	33	44	20	133,00	
6093600	600	840	770	36	54	20	226,50	
6093700	700	910	840	36	38	24	186,00	UNI
6093800	800	1025	950	39	38	24	237,00	UNI
6093900	900	1125	1050	39	40	28	301,00	UNI
60931000	1000	1255	1170	42	42	28	395,00	UNI

FLANGE CIECA EN 1092-05 A PN 25

CODICE	DN	D	a	f	b	n.fori	kg	PREZZO €
6094200	200	360	310	26	30	12	22,60	
6094250	250	425	370	30	32	12	33,50	
6094300	300	485	430	30	34	16	46,30	
6094350	350	555	490	33	38	16	68,10	
6094400	400	620	550	36	40	16	89,70	

FLANGE CIECA EN 1092-05 A PN 40

CODICE	DN	D	a	f	b	n.fori	kg	PREZZO €
609550	50	165	125	18	20	4	3,00	
609565	65	185	145	18	22	8	4,50	
609580	80	200	160	18	24	8	5,50	
6095100	100	235	190	22	24	8	7,50	
6095125	125	270	220	26	26	8	11,00	
6095150	150	300	250	26	28	8	14,50	
6095200	200	375	320	30	36	12	29,00	
6095250	250	450	385	33	38	12	44,50	
6095300	300	515	450	33	42	16	64,00	
6095350	350	580	510	36	46	16	89,50	
6095400	400	660	585	39	50	16	127,00	

TIPO 11B

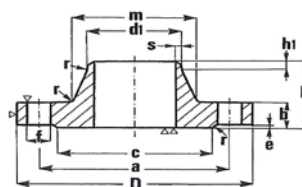

FLANGE COLLARINO EN 1092-1 11 B PN 6

CODICE	DN	D	d1	f	b	a	n.fori	KG	PREZZO €
228025	25	100	34,50	11	14	75	4	0,75	
228032	32	120	43,50	14	14	90	4	1,05	
228040	40	130	49,50	14	14	100	4	1,26	
228050	50	140	61,50	14	14	110	4	1,42	
228065	65	160	77,00	14	14	130	4	1,77	
228080	80	190	90,00	18	16	150	4	2,83	
2280100	100	210	115,50	18	16	170	4	3,34	
2280125	125	240	141,00	18	18	200	8	4,57	
2280150	150	265	170,50	18	18	225	8	5,21	
2280200	200	320	221,00	18	20	280	8	8,20	
2280250	250	375	275,00	18	22	335	12	11,11	
2280300	300	440	326,00	22	22	395	12	14,80	

FLANGE COLLARINO EN 1092-1 11 B PN 10

CODICE	DN	D	d1	f	b	a	n.fori	KG	PREZZO €
228180	80	200	90	18	20	160	8	4,00	
2281200	200	340	221	22	24	295	12	11,50	
2281250	250	395	275	22	26	350	12	15,21	
2281300	300	445	326	22	26	400	16	18,20	
2281350	350	505	357,5	22	26	460	16	24,50	
2281400	400	565	408,5	26	26	515	20	29,50	
2281450	450	615	459	26	26	565	20	34,00	
2281500	500	670	510	26	28	620	20	39,50	
2281600	600	780	611,5	30	28	725	24	56,00	

FLANGE COLLARINO EN 1092-1 11 B PN 16

CODICE	DN	D	d1	f	b	a	n.fori	KG	PREZZO €
228215	15	95	22,5	14	16	65	4	0,75	
228220	20	105	28	14	18	75	4	1,10	
228225	25	115	34,5	14	18	85	4	1,28	
228232	32	140	43,5	18	18	100	4	1,86	
228240	40	150	49,5	18	18	110	4	2,16	
228250	50	165	61,5	18	18	125	4	2,60	
228265	65	185	77	18	18	145	8	3,16	
228280	80	200	90	18	20	160	8	3,93	
2282100	100	220	115,5	18	20	180	8	4,53	
2282125	125	250	141	18	22	210	8	6,22	
2282150	150	285	170,5	22	22	240	8	7,60	
2282200	200	340	221	22	24	295	12	11,00	
2282250	250	405	275	26	26	355	12	16,20	
2282300	300	460	326	26	28	410	12	21,99	
2282350	350	520	357,5	26	30	470	16	32,21	
2282400	400	580	408,5	30	32	525	16	40,30	
2282450	450	640	459	30	40	585	20	54,50	
2282500	500	715	510	33	44	650	20	74,00	
2282600	600	840	611,5	36	54	770	20	116,50	



TIPO 11B

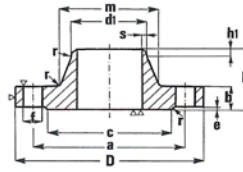

FLANGE COLLARINO EN 1092-1 11 B PN 25

CODICE	DN	D	d1	f	b	a	n.fori	KG	PREZZO €
2283200	200	360	221	26	32	310	12	17,00	
2283250	250	425	275	30	35	370	12	24,00	
2283300	300	485	326	30	38	430	16	31,50	
2283350	350	555	357,5	33	42	490	16	48,00	
2283400	400	620	408,5	36	46	550	16	63,00	

FLANGE COLLARINO EN 1092-1 11 B PN 40

CODICE	DN	D	d1	f	b	a	n.fori	KG	PREZZO €
228450	50	165	61,5	18	20	125	4	2,87	
228465	65	185	77	18	22	145	8	3,71	
228480	80	200	90	18	24	160	8	4,74	
2284100	100	235	115,5	22	24	190	8	6,42	
2284125	125	270	141	26	26	220	8	8,81	
2284150	150	300	170,5	26	28	250	8	11,50	
2284200	200	375	221	30	34	320	12	20,79	
2284250	250	450	275	33	38	385	12	33,77	
2284300	300	515	326	33	42	450	16	47,50	a richiesta



TIPO 13A

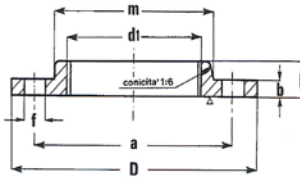

FLANGE FILETTATE EN 1092-1 13 A PN 6

CODICE	DN	D	d1	f	b	a	n.fori	KG	PREZZO €
225315	15	80	1/2"	11	12	55	4	0,43	
225320	20	90	3/4"	11	14	65	4	0,66	
225325	25	100	1"	11	14	75	4	0,82	
225332	32	120	1"1/4	14	14	90	4	1,17	
225340	40	130	1"1/2	14	14	100	4	1,40	
225350	50	140	2"	14	14	110	4	1,59	
225365	65	160	2"1/2	14	14	130	4	2,17	
225380	80	190	3"	18	16	150	4	3,20	
2253100	100	210	4"	18	16	170	4	3,59	

FLANGE FILETTATE EN 1092-1 13 A PN 16

CODICE	DN	D	d1	f	b	a	n.fori	KG	PREZZO €
225415	15	95	1/2"	14	14	65	4	0,70	
225420	20	105	3/4"	14	16	75	4	1,01	
225425	25	115	1"	14	16	85	4	1,21	
225432	32	140	1"1/4	18	16	100	4	1,76	
225440	40	150	1"1/2	18	16	110	4	2,04	
225450	50	165	2"	18	18	125	4	2,85	
225465	65	185	2"1/2	18	18	145	8	3,53	
225480	80	200	3"	18	20	160	8	4,24	
2254100	100	220	4"	18	20	180	8	5,30	
2254125	125	250	5"	18	22	210	8	8,00	
2254150	150	285	6"	22	22	240	8	8,49	

FLANGE ZINCATE

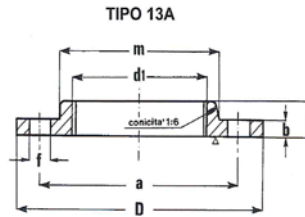

FLANGE FILETTATE EN 1092-1 13 A PN 16 ZINCATE

CODICE	DN	D	d1	f	b	a	n.fori	KG	PREZZO €
225425ZC	25	115	1"	14	16	85	4	1,21	
225432ZC	32	140	1"1/4	18	16	100	4	1,76	
225440ZC	40	150	1"1/2	18	16	110	4	2,04	
225450ZC	50	165	2"	18	18	125	4	2,85	
225465ZC	65	185	2"1/2	18	18	145	8	3,53	
225480ZC	80	200	3"	18	20	160	8	4,24	
2254100ZC	100	220	4"	18	20	180	8	5,30	
2254125ZC	125	250	5"	18	22	210	8	8,00	

FLANGE LIBERE EN 1092-2 A PN 16 ZINCATE

CODICE	DN	D	f	b	a	n.fori	Kg	PREZZO €
609015ZC	15	95	14	14	65	4	0,66	
609020ZC	20	105	14	16	75	4	0,91	
609025ZC	25	115	14	16	85	4	1,07	
609032ZC	32	140	18	18	100	4	1,79	
609040ZC	40	150	18	18	110	4	2,03	
609050ZC	50	165	18	19	125	4	2,52	
609065ZC	65	185	18	20	145	8	3,12	
609080ZC	80	200	18	20	160	8	4,42	
6090100ZC	100	220	18	22	180	8	4,15	
6090125ZC	125	250	18	22	210	8	5,10	
6090150ZC	150	285	22	24	240	8	6,87	
6090200ZC	200	340	22	26	295	12	9,27	
6090250ZC	250	405	26	29	355	12	13,79	
6090300ZC	300	460	26	32	410	12	18,23	

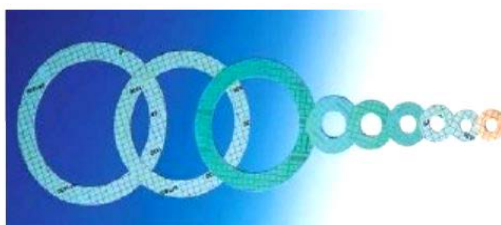

GUARNIZIONI IN FIBRA PER FLANGE EN

PN 6			PN 10			PN 16		
CODICE	DN	PREZZO €	CODICE	DN	prezzo €	CODICE	DN	PREZZO €
GG2156	15					GG21516	15	
GG2206	20					GG22016	20	
GG2256	25					GG22516	25	
GG2326	32					GG23216	32	
GG2406	40					GG24016	40	
GG2506	50					GG25016	50	
GG2656	65					GG26516	65	
GG2806	80					GG28016	80	
GG21006	100					GG210016	100	
GG21256	125					GG212516	125	
GG21506	150					GG215016	150	
GG22006	200		GG220010	200	4,42	GG220016	200	
GG22506	250		GG225010	250	5,59	GG225016	250	
GG23006	300		GG230010	300	6,19	GG230016	300	
GG23506	350		GG235010	350	8,23	GG235016	350	
GG24006	400		GG240010	400	10,30	GG240016	400	
GG24506	450		GG245010	450	11,18	GG245016	450	
GG25006	500		GG250010	500	13,85	GG250016	500	
GG26006	600		GG260010	600	15,67	GG260016	600	
GG27006	700		GG270010	700	29,93	GG270016	700	
GG28006	800		GG280010	800	38,50	GG280016	800	
GG29006	900		GG290010	900		GG290016	900	
GG210006	1000		GG2100010	1000	57,02	GG2100016	1000	

GUARNIZIONI IN GOMMA TELATA PER FLANGE EN

PN 6			PN 10			PN 16		
CODICE	DN	PREZZO €	CODICE	DN	prezzo €	CODICE	DN	PREZZO €
GG3156	15					GG31516	15	
GG3206	20					GG32016	20	
GG3256	25					GG32516	25	
GG3326	32					GG33216	32	
GG3406	40					GG34016	40	
GG3506	50					GG35016	50	
GG3656	65					GG36516	65	
GG3806	80					GG38016	80	
GG31006	100					GG310016	100	
GG31256	125					GG312516	125	
GG31506	150					GG315016	150	
GG32006	200		GG320010	200	2,90	GG320016	200	
GG32506	250		GG325010	250	4,03	GG325016	250	
GG33006	300		GG330010	300	5,66	GG330016	300	
GG33506	350		GG335010	350	7,08	GG335016	350	
GG34006	400		GG340010	400	7,85	GG340016	400	
GG34506	450		GG345010	450	9,60	GG345016	450	
GG35006	500		GG350010	500	11,33	GG350016	500	
GG36006	600		GG360010	600	14,26	GG360016	600	
GG37006	700		GG370010	700	19,97	GG370016	700	
GG38006	800		GG380010	800	28,51	GG380016	800	
GG39006	900		GG390010	900		GG390016	900	
GG310006	1000		GG3100010	1000	35,64	GG3100016	1000	

VITI TE UNI 5737 IN ACCIAIO ZINCATO PER FLANGE EN



CODICE	BULLONI			PER FLANGE PN6	PER FLANGE PN 10	PER FLANGE PN 16	PREZZO €
	bulloni	x	lung.	DN	DN	DN	
B1040	M10	x	40	15			
B1045	M10	x	45	20-25			
B1245	M12	x	45	32-40-50-65			
B1250	M12	x	50			15-20-25	
B1660	M16	x	60	80-100		32.40-50-65	
B1665	M16	x	65	125-150		80-100	
B1670	M16	x	70	200-250		125	
B2080	M20	x	80	300-350-400-500	200	150-200	
B2090	M20	x	90		250-300-350		
B2290	M22	x	90	600-700	400-450-500	250-300	
B22100	M22	x	100			350	
B2790	M27	x	90	800			
B27100	M27	x	100	1000	600-700	400-450	
B30110	M30	x	110		800	500	
B33120	M33	x	120		1000	600-700	
B33135	M33	x	135			800-1000	

DADI ESAGONALI UNI 5588 IN ACCIAIO ZINCATO PER FLANGE EN

CODICE	dadi	H		PREZZO €
D10	M10	8		
D12	M12	10		
D16	M16	13		
D20	M20	16		
D22	M22	18		
D27	M27	22		
D30	M30	24		
D33	M33	50		



RONDELLE PIANE UNI 6592/125A IN ACCIAIO ZINCATO PER FLANGE EN

CODICE	rondelle	sp/mm		PREZZO €
R10	D10	2,0		
R12	D12	2,5		
R16	D16	3,0		
R20	D20	3,0		
R22	D22	3,0		
R27	D27	4,0		
R30	D30	4,0		
R33	D33	5,0		



FLANGE ASA 150 SLIP-ON

CODICE	DN	D	k	n.fori	kg	PREZZO €
ASA150SO1/2	1/2"	89,0	60,3	4	0,4	
ASA150SO34	3/4"	98,5	69,9	4	0,7	
ASA150SO1	1"	108,0	79,4	4	0,8	
ASA150SO114	1"1/4	117,0	88,9	4	1,2	
ASA150SO112	1"1/2	127,0	98,4	4	1,4	
ASA150SO2	2"	152,5	120,7	4	2,2	
ASA150SO212	2"1/2	178,0	139,7	4	3,5	
ASA150SO3	3"	190,0	152,4	4	3,8	
ASA150SO4	4"	228,5	190,5	8	5,6	
ASA150SO5	5"	254,0	215,9	8	6,5	
ASA150SO6	6"	279,5	241,3	8	8,1	
ASA150SO8	8"	323,0	298,4	8	13	
ASA150SO10	10"	406,5	361,9	8	18,4	
ASA150SO12	12"	482,5	431,8	12	28,5	
ASA150SO14	14"	533,5	476,2	12	37,5	
ASA150SO16	16"	597,0	539,7	12	44,5	
ASA150SO18	18"	635,0	577,8	16	54	
ASA150SO20	20"	698,5	635,0	16	72	

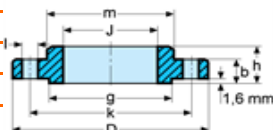

FLANGE ASA 150 WELDING-NECK

CODICE	DN	D	k	n.fori	kg	PREZZO €
ASA150WN1/2	1/2"	89,0	60,3	4	0,7	
ASA150WN34	3/4"	98,5	69,9	4	0,8	
ASA150WN1	1"	108,0	79,4	4	1,1	
ASA150WN114	1"1/4	117,0	88,9	4	1,5	
ASA150WN112	1"1/2	127,0	98,4	4	1,8	
ASA150WN2	2"	152,5	120,7	4	2,7	
ASA150WN212	2"1/2	178,0	139,7	4	4,4	
ASA150WN3	3"	190,0	152,4	4	5,2	
ASA150WN4	4"	228,5	190,5	8	7,5	
ASA150WN5	5"	254,0	215,9	8	9,2	
ASA150WN6	6"	279,5	241,3	8	11	
ASA150WN8	8"	323,0	298,4	8	18,4	
ASA150WN10	10"	406,5	361,9	8	25,5	
ASA150WN12	12"	482,5	431,8	12	37	
ASA150WN14	14"	533,5	476,2	12	51	
ASA150WN16	16"	597,0	539,7	12	61,5	
ASA150WN18	18"	635,0	577,8	16	71,5	
ASA150WN20	20"	698,5	635,0	16	85	

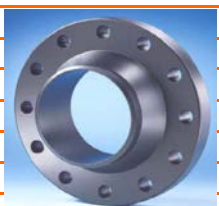
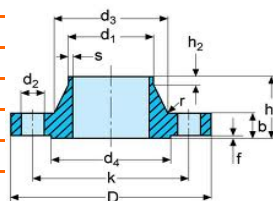

FLANGE ASA 150 BLIND

CODICE	DN	D	k	n.fori	kg	PREZZO €
ASA150BL1/2	1/2"	89,0	60,3	4	0,5	
ASA150BL34	3/4"	98,5	69,9	4	0,8	
ASA150BL1	1"	108,0	79,4	4	0,9	
ASA150BL114	1"1/4	117,0	88,9	4	1,3	
ASA150BL112	1"1/2	127,0	98,4	4	1,6	
ASA150BL2	2"	152,5	120,7	4	2,6	
ASA150BL212	2"1/2	178,0	139,7	4	4,1	
ASA150BL3	3"	190,0	152,4	4	5,1	
ASA150BL4	4"	228,5	190,5	8	7,5	
ASA150BL5	5"	254,0	215,9	8	9,2	
ASA150BL6	6"	279,5	241,3	8	11,8	
ASA150BL8	8"	323,0	298,4	8	20,4	
ASA150BL10	10"	406,5	361,9	8	31	
ASA150BL12	12"	482,5	431,8	12	47	
ASA150BL14	14"	533,5	476,2	12	60	
ASA150BL16	16"	597,0	539,7	12	81	
ASA150BL18	18"	635,0	577,8	16	93	
ASA150BL20	20"	698,5	635,0	16	127	

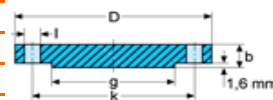

FLANGE ASA 300 SLIP-ON

CODICE	DN	D	k	n.fori	kg	PREZZO €
ASA300SO1/2	1/2"	95,50	66,7	4	0,7	
ASA300SO3/4	3/4"	117,5	82,5	4	1,2	
ASA300SO1	1"	124,0	88,9	4	1,4	
ASA300SO114	1"1/4	133,5	98,4	4	1,8	
ASA300SO112	1"1/2	155,5	114,3	4	2,7	
ASA300SO2	2"	165,0	127,0	8	3,2	
ASA300SO212	2"1/2	190,5	149,2	8	4,5	
ASA300SO3	3"	209,5	168,3	8	5,9	
ASA300SO4	4"	254,0	200,0	8	10	
ASA300SO5	5"	279,5	234,9	8	12,5	
ASA300SO6	6"	317,5	269,9	12	16,5	
ASA300SO8	8"	381,0	330,2	12	25,5	
ASA300SO10	10"	444,5	387,3	16	35	
ASA300SO12	12"	520,5	450,8	16	52	

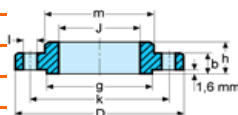

FLANGE ASA 300 WELDING-NECK

CODICE	DN	D	k	n.fori	kg	PREZZO €
ASA300WN1/2	1/2"	95,50	66,7	4	0,8	
ASA300WN3/4	3/4"	117,5	82,5	4	1,4	
ASA300WN1	1"	124,0	88,9	4	1,7	
ASA300WN114	1"1/4	133,5	98,4	4	2,2	
ASA300WN112	1"1/2	155,5	114,3	4	3,2	
ASA300WN2	2"	165,0	127,0	8	3,6	
ASA300WN212	2"1/2	190,5	149,2	8	5,4	
ASA300WN3	3"	209,5	168,3	8	7,3	
ASA300WN4	4"	254,0	200,0	8	11,8	
ASA300WN5	5"	279,5	234,9	8	16	
ASA300WN6	6"	317,5	269,9	12	20,2	
ASA300WN8	8"	381,0	330,2	12	31,2	
ASA300WN10	10"	444,5	387,3	16	44,3	
ASA300WN12	12"	520,5	450,8	16	63,5	

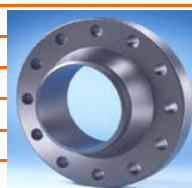
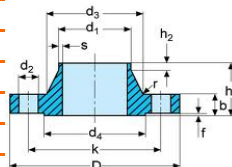

FLANGE ASA 300 BLIND

CODICE	DN	D	k	n.fori	kg	PREZZO €
ASA300BL1/2	1/2"	95,50	66,7	4	0,8	
ASA300BL3/4	3/4"	117,5	82,5	4	1,2	
ASA300BL1	1"	124,0	88,9	4	1,5	
ASA300BL114	1"1/4	133,5	98,4	4	2	
ASA300BL112	1"1/2	155,5	114,3	4	2,9	
ASA300BL2	2"	165,0	127,0	8	3,5	
ASA300BL212	2"1/2	190,5	149,2	8	5,3	
ASA300BL3	3"	209,5	168,3	8	7,2	
ASA300BL4	4"	254,0	200,0	8	12,2	
ASA300BL5	5"	279,5	234,9	8	16	
ASA300BL6	6"	317,5	269,9	12	22	
ASA300BL8	8"	381,0	330,2	12	36	
ASA300BL10	10"	444,5	387,3	16	55	
ASA300BL12	12"	520,5	450,8	16	82,5	

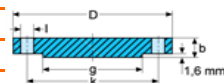

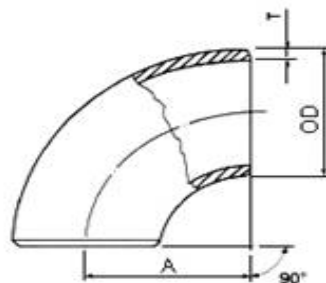

CURVE LONG RADIUS SCHEDULA STD 90° MATERIALE : WPB ASTM A-234

CODICE	Ø	OD mm	T	raggio/A	schedula	Kg x 90°	PREZZO €
CUSTD21	1/2"	21,3	2,77	27,5	std / sch 40	0,08	
CUSTD26	3/4"	26,7	2,87	28,5	std / sch 40	0,08	
CUSTD33	1"	33,4	3,38	38,1	std / sch 40	0,15	
CUSTD42	1"1/4	42,2	3,56	47,6	std / sch 40	0,26	
CUSTD48	1"1/2	48,3	3,68	57,2	std / sch 40	0,36	
CUSTD60	2"	60,3	3,91	76,2	std / sch 40	0,65	
CUSTD73	2"1/2	73,0	5,16	95,2	std / sch 40	1,30	
CUSTD88	3"	88,9	5,49	114,3	std / sch 40	2,10	
CUSTD101	3"1/2	101,6	5,74	133,4	std / sch 40	3,00	
CUSTD114	4"	114,3	6,02	152,4	std / sch 40	4,00	
CUSTD141	5"	141,3	6,55	190,5	std / sch 40	6,70	
CUSTD168	6"	168,3	7,11	228,6	std / sch 40	10,40	
CUSTD219	8"	219,1	8,18	304,8	std / sch 40	20,90	
CUSTD273	10"	273,0	9,27	381,0	std / sch 40	37,00	
CUSTD323	12"	323,8	9,52	457,2	std / sch 40	54,00	
CUSTD355	14"	355,6	9,52	533,4	std / sch 40	69,00	
CUSTD406	16"	406,4	9,52	609,6	std / sch 40	90,00	
CUSTD457	18"	457,2	9,52	685,8	std / sch 40	114,00	
CUSTD508	20"	508,0	9,52	762,0	std / sch 40	141,00	
CUSTD609	24"	609,6	9,52	914,4	std / sch 40	203,00	
CUSTD711	28"	711,2	9,52	1067,0	std / sch 40	280,00	
CUSTD812	32"	812,8	9,52	1219,0	std / sch 40	363,00	
CUSTD914	36"	914,4	9,52		std / sch 40	460,00	
CUSTD1016	40"	1016,0	9,52		std / sch 40	547,00	

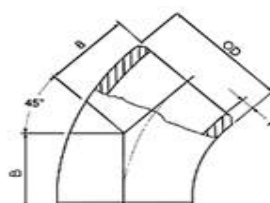

CURVE LONG RADIUS SCHEDULA STD 45° MATERIALE : WPB ASTM A-234

CODICE	Ø	OD/mm	T	schedula	PREZZO €
CUSTD4542	1"1/4	42,2	3,56	std / sch 40	
CUSTD4548	1"1/2	48,3	3,68	std / sch 40	
CUSTD4560	2"	60,3	3,91	std / sch 40	
CUSTD4573	2"1/2	73,0	5,16	std / sch 40	
CUSTD4588	3"	88,9	5,49	std / sch 40	
CUSTD45101	3"1/2	101,6	5,74	std / sch 40	
CUSTD45114	4"	114,3	6,02	std / sch 40	
CUSTD45141	5"	141,3	6,55	std / sch 40	
CUSTD45168	6"	168,3	7,11	std / sch 40	
CUSTD45219	8"	219,1	8,18	std / sch 40	
CUSTD45273	10"	273,0	9,27	std / sch 40	
CUSTD45323	12"	323,8	9,52	std / sch 40	
CUSTD45355	14"	355,6	9,52	std / sch 40	
CUSTD45406	16"	406,4	9,52	std / sch 40	
CUSTD45457	18"	457,2	9,52	std / sch 40	

CURVE LONG RADIUS SCHEDULA STD 45° MATERIALE : WPB ASTM A-234

CODICE	Ø	OD/mm	T	schedula	PREZZO €
CUSTD45508	20"	508,0	9,52	std / sch 40	
CUSTD45609	24"	609,6	9,52	std / sch 40	
CUSTD45711	28"	711,2	9,52	std / sch 40	
CUSTD45812	32"	812,8	9,52	std / sch 40	
CUSTD45914	36"	914,4	9,52	std / sch 40	
CUSTD451016	40"	1016,0	9,52	std / sch 40	

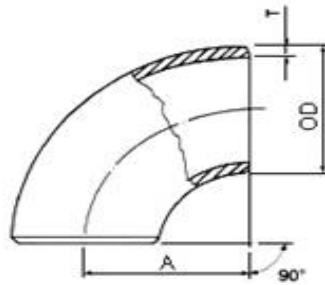

CURVE SHORT RADIUS SCHEDULA STD 90° MATERIALE : WPB ASTM A-234

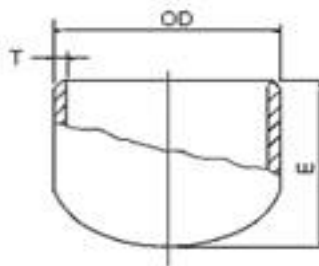
CODICE	Ø	OD mm	T	raggio/A	schedula	Kg x 90°	PREZZO €
CUSTD33	1"	33,4	3,38	25,4	std / sch 40	0,10	
CUSTD42	1"1/4	42,2	3,56	31,8	std / sch 40	0,18	
CUSTD48	1"1/2	48,3	3,68	38,1	std / sch 40	0,30	
CUSTD60	2"	60,3	3,91	55,8	std / sch 40	0,60	
CUSTD73	2"1/2	73,0	5,16	63,5	std / sch 40	0,95	
CUSTD88	3"	88,9	5,49	76,2	std / sch 40	1,35	
CUSTD114	4"	114,3	6,02	101,6	std / sch 40	2,70	
CUSTD141	5"	141,3	6,55	127,0	std / sch 40	4,70	
CUSTD168	6"	168,3	7,11	152,4	std / sch 40	7,30	
CUSTD219	8"	219,1	8,18	203,2	std / sch 40	15,00	
CUSTD273	10"	273,0	9,27	254,0	std / sch 40	26,00	
CUSTD323	12"	323,8	9,52	304,8	std	30,00	

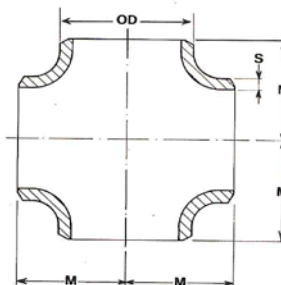
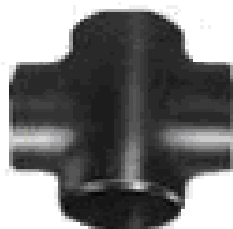

FONDI BOMBATI SCHEDULA STD MATERIALE : WPB ASTM A-234

CODICE	Ø	OD/mm	T	kg	PREZZO €
FOSTD26	3/4"	26,7	2,87	0,08	
FOSTD33	1"	33,4	3,38	0,10	
FOSTD42	1"1/4	42,2	3,56	0,20	
FOSTD48	1"1/2	48,3	3,68	0,25	
FOSTD60	2"	60,3	3,91	0,30	
FOSTD73	2"1/2	73,0	5,16	0,38	
FOSTD88	3"	88,9	5,49	0,65	
FOSTD101	3"1/2	101,6	5,74	1,10	
FOSTD114	4"	114,3	6,02	1,20	
FOSTD141	5"	141,3	6,55	2,10	
FOSTD168	6"	168,3	7,11	3,60	
FOSTD219	8"	219,1	8,18	5,50	
FOSTD273	10"	273,0	9,27	10,00	
FOSTD323	12"	323,8	9,52	14,00	
FOSTD355	14"	355,6	9,52	17,00	
FOSTD406	16"	406,4	9,52	23,00	
FOSTD457	18"	457,2	9,52	28,00	
FOSTD508	20"	508,0	9,52	35,00	
FOSTD609	24"	609,6	9,52	44,00	



CROCI SCHEDULA STD MATERIALE : WPB ASTM A-234

CODICE	Ø	OD/mm	S	M	kg	PREZZO €
CRSTD60	2"	60,3	3,91	64	1,30	
CRSTD73	2"1/2	73,0	5,16	76	2,35	
CRSTD88	3"	88,9	5,49	86	3,50	
CRSTD114	4"	114,3	6,02	105	5,70	
CRSTD141	5"	141,3	6,55	124	9,10	
CRSTD168	6"	168,3	7,10	143	13,00	
CRSTD219	8"	219,1	8,18	178	24,70	
CRSTD273	10"	273,0	9,27	216	39,00	
CRSTD323	12"	323,8	9,52	254	61,00	

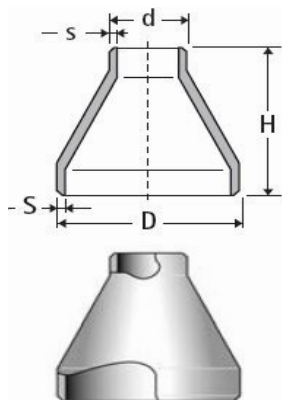

RIDUZIONI CONCENTRICHE SCHEDULA STD MATERIALE : WPB ASTM A-234

CODICE	D	d	S	s	H	kg	PREZZO €
RCSTD3326	1"	x 3/4"	3,38	2,77	50	0,1	
RCSTD3321	1"	x 1/2"	3,38	2,87	50	0,1	
RCSTD4233	1"1/4	x 1"	3,56	3,38	50	0,2	
RCSTD4226	1"1/4	x 3/4"	3,56	2,87	50	0,2	
RCSTD4221	1"1/4	x 1/2"	3,56	2,77	50	0,2	
RCSTD4842	1"1/2	x 1"1/4	3,68	3,56	64	0,3	
RCSTD4833	1"1/2	x 1"	3,68	3,38	64	0,2	
RCSTD4826	1"1/2	x 3/4"	3,68	2,87	64	0,2	
RCSTD4821	1"1/2	x 1/2"	3,68	2,77	64	0,2	
RCSTD6048	2"	x 1"1/2	3,91	3,68	76	0,4	
RCSTD6042	2"	x 1"1/4	3,91	3,56	76	0,4	
RCSTD6033	2"	x 1"	3,91	3,38	76	0,4	
RCSTD6026	2"	x 3/4"	3,91	2,87	76	0,4	
RCSTD7360	2"1/2	x 2"	5,16	3,91	90	0,7	
RCSTD7348	2"1/2	x 1"1/2	5,16	3,68	90	0,7	
RCSTD7342	2"1/2	x 1"1/4	5,16	3,56	90	0,7	
RCSTD7333	2"1/2	x 1"	5,16	3,38	90	0,7	
RCSTD8873	3"	x 2"1/2	5,49	5,16	90	1,0	
RCSTD8860	3"	x 2"	5,49	3,91	90	0,9	
RCSTD8848	3"	x 1"1/2	5,49	3,68	90	0,9	
RCSTD8842	3"	x 1"1/4	5,49	3,56	90	0,9	
RCSTD11488	4"	x 3"	6,02	5,49	100	1,6	
RCSTD11473	4"	x 2"1/2	6,02	5,16	100	1,5	
RCSTD11460	4"	x 2"	6,02	3,91	100	1,5	
RCSTD11448	4"	x 1"1/2	6,02	3,68	100	1,5	
RCSTD141114	5"	x 4"	6,55	6,02	127	2,7	
RCSTD14188	5"	x 3"	6,55	5,49	127	2,6	
RCSTD14173	5"	x 2"1/2	6,55	5,16	127	2,5	
RCSTD14160	5"	x 2"	6,55	3,91	127	2,4	
RCSTD168141	6"	x 5"	7,11	6,55	140	3,9	
RCSTD168114	6"	x 4"	7,11	6,02	140	3,7	
RCSTD16888	6"	x 3"	7,11	5,49	140	3,6	
RCSTD16873	6"	x 2"1/2	7,11	5,16	140	3,6	
RCSTD219168	8"	x 6"	8,18	7,11	152	6,3	
RCSTD219141	8"	x 5"	8,18	6,55	152	6,1	
RCSTD219114	8"	x 4"	8,18	6,02	152	6,0	
RCSTD21988	8"	x 3"	8,18	5,49	152	6,0	
RCSTD273219	10"	x 8"	9,27	8,18	178	10,5	
RCSTD273168	10"	x 6"	9,27	7,11	178	10,3	
RCSTD273141	10"	x 5"	9,27	6,55	178	10,2	
RCSTD273114	10"	x 4"	9,27	6,02	178	10,2	
RCSTD323273	12"	x 10"	9,52	9,27	203	15,0	
RCSTD323219	12"	x 8"	9,52	8,18	203	15,0	
RCSTD323168	12"	x 6"	9,52	7,11	203	15,0	
RCSTD323141	12"	x 5"	9,52	6,55	203	15,0	
RCSTD355323	14"	x 12"	9,52	9,52	330	30,0	
RCSTD355273	14"	x 10"	9,52	9,27	330	30,0	
RCSTD355219	14"	x 8"	9,52	8,18	330	30,0	
RCSTD355168	14"	x 6"	9,52	7,11	330	30,0	

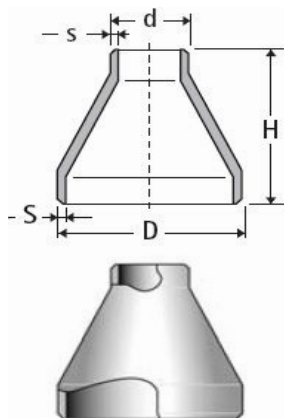

RIDUZIONI CONCENTRICHE SCHEDULA STD MATERIALE : WPB ASTM A-234

CODICE	D	d	S	s	H	Kg	PREZZO €
RCSTD406355	16"	14"	9,52	9,52	356	37	
RCSTD406323	16"	12"	9,52	9,52	356	37	
RCSTD406273	16"	10"	9,52	9,27	356	37	
RCSTD406219	16"	8"	9,52	8,18	356	37	
RCSTD457406	18"	16"	9,52	9,52	381	45	
RCSTD457355	18"	14"	9,52	9,52	381	45	
RCSTD457323	18"	12"	9,52	9,52	381	45	
RCSTD457273	18"	10"	9,52	9,27	381	45	
RCSTD508457	20"	18"	9,52	9,52	508	68	
RCSTD508406	20"	16"	9,52	9,52	508	68	
RCSTD508355	20"	14"	9,52	9,52	508	68	
RCSTD508323	20"	12"	9,52	9,52	508	68	
RCSTD508273	20"	10"	9,52	9,27	508	68	
RCSTD508219	20"	8"	9,52	8,18	508	68	
RCSTD609508	24"	20"	9,52	9,52	508	77	
RCSTD609457	24"	18"	9,52	9,52	508	77	
RCSTD609406	24"	16"	9,52	9,52	508	77	
RCSTD609355	24"	14"	9,52	9,52	508	77	
RCSTD609323	24"	12"	9,52	9,52	508	77	
RCSTD711609	28"	24"	9,52	9,52		105	
RCSTD711508	28"	20"	9,52	9,52		105	
RCSTD711406	28"	16"	9,52	9,52		105	
RCSTD812711	32"	28"	9,52	9,52		105	
RCSTD812609	32"	24"	9,52	9,52		125	
RCSTD812508	32"	20"	9,52	9,52		125	

RIDUZIONI ECCENTRICHE SCHEDULA STD MATERIALE : WPB ASTM A-234

CODICE	D	d	S	s	H	Kg	PREZZO €
RESTD3326	1"	x 3/4"	3,38	2,77	50	0,14	
RESTD3321	1"	x 1/2"	3,38	2,87	50	0,13	
RESTD4233	1"1/4	x 1"	3,56	3,38	50	0,20	
RESTD4226	1"1/4	x 3/4"	3,56	2,87	50	0,20	
RESTD4221	1"1/4	x 1/2"	3,56	2,77	50	0,20	
RESTD4842	1"1/2	x 1"1/4	3,68	3,56	64	0,26	
RESTD4833	1"1/2	x 1"	3,68	3,38	64	0,24	
RESTD4826	1"1/2	x 3/4"	3,68	2,87	64	0,22	
RESTD4821	1"1/2	x 1/2"	3,68	2,77	64	0,22	
RESTD6048	2"	x 1"1/2	3,91	3,68	76	0,41	
RESTD6042	2"	x 1"1/4	3,91	3,56	76	0,39	
RESTD6033	2"	x 1"	3,91	3,38	76	0,37	
RESTD6026	2"	x 3/4"	3,91	2,87	76	0,37	
RESTD7360	2"1/2	x 2"	5,16	3,91	90	0,70	
RESTD7348	2"1/2	x 1"1/2	5,16	3,68	90	0,68	
RESTD7342	2"1/2	x 1"1/4	5,16	3,56	90	0,67	
RESTD7333	2"1/2	x 1"	5,16	3,38	90	0,67	
RESTD8873	3"	x 2"1/2	5,49	5,16	90	0,95	
RESTD8860	3"	x 2"	5,49	3,91	90	0,90	
RESTD8848	3"	x 1"1/2	5,49	3,68	90	0,86	
RESTD8842	3"	x 1"1/4	5,49	3,56	90	0,86	
RESTD11488	4"	x 3"	6,02	5,49	100	1,58	
RESTD11473	4"	x 2"1/2	6,02	5,16	100	1,50	
RESTD11460	4"	x 2"	6,02	3,91	100	1,45	
RESTD11448	4"	x 1"1/2	6,02	3,68	100	1,45	
RESTD141114	5"	x 4"	6,55	6,02	127	2,74	
RESTD14188	5"	x 3"	6,55	5,49	127	2,60	
RESTD14173	5"	x 2"1/2	6,55	5,16	127	2,50	
RESTD14160	5"	x 2"	6,55	3,91	127	2,40	
RESTD168141	6"	x 5"	7,11	6,55	140	3,91	
RESTD168114	6"	x 4"	7,11	6,02	140	3,71	
RESTD16888	6"	x 3"	7,11	5,49	140	3,63	
RESTD16873	6"	x 2"1/2	7,11	5,16	140	3,60	
RESTD219168	8"	x 6"	8,18	7,11	152	6,30	
RESTD219141	8"	x 5"	8,18	6,55	152	6,08	
RESTD219114	8"	x 4"	8,18	6,02	152	5,95	
RESTD21988	8"	x 3"	8,18	5,49	152	5,95	
RESTD273219	10"	x 8"	9,27	8,18	178	10,5	
RESTD273168	10"	x 6"	9,27	7,11	178	10,3	
RESTD273141	10"	x 5"	9,27	6,55	178	10,2	
RESTD273114	10"	x 4"	9,27	6,02	178	10,2	
RESTD323273	12"	x 10"	9,52	9,27	203	15,0	
RESTD323219	12"	x 8"	9,52	8,18	203	15,0	
RESTD323168	12"	x 6"	9,52	7,11	203	15,0	
RESTD323141	12"	x 5"	9,52	6,55	203	15,0	
RESTD355323	14"	x 12"	9,52	9,52	330	30,0	
RESTD355273	14"	x 10"	9,52	9,27	330	30,0	
RESTD355219	14"	x 8"	9,52	8,18	330	30,0	
RESTD355168	14"	x 6"	9,52	7,11	330	30,0	

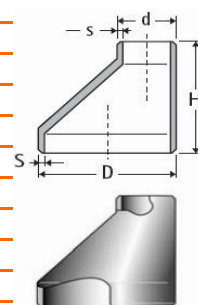

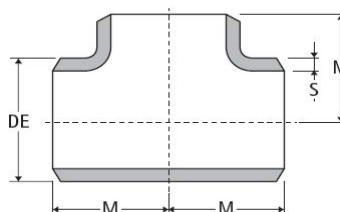

TEE NORMALI SCHEDULA STD MATERIALE : WPB ASTM A-234

CODICE	Ø	DE	S	M	schedula	kg	PREZZO €
TEENSTD21	1/2"	21,3	2,77	25	std / sch 40	0,10	
TEENSTD26	3/4"	26,7	2,87	30	std / sch 40	0,16	
TEENSTD33	1"	33,4	3,38	38	std / sch 40	0,36	
TEENSTD42	1"1/4	42,2	3,56	48	std / sch 40	0,50	
TEENSTD48	1"1/2	48,3	3,68	57	std / sch 40	0,70	
TEENSTD60	2"	60,3	3,91	64	std / sch 40	1,00	
TEENSTD73	2"1/2	73,0	5,16	76	std / sch 40	1,80	
TEENSTD88	3"	88,9	5,49	86	std / sch 40	2,70	
TEENSTD101	3"1/2	101,6	5,74	95	std / sch 40	3,55	
TEENSTD114	4"	114,3	6,02	105	std / sch 40	4,40	
TEENSTD141	5"	141,3	6,55	124	std / sch 40	7,00	
TEENSTD168	6"	168,3	7,11	143	std / sch 40	10,00	
TEENSTD219	8"	219,1	8,18	178	std / sch 40	19,00	
TEENSTD273	10"	273,0	9,27	216	std / sch 40	30,00	
TEENSTD323	12"	323,8	9,52	254	std	47,00	
TEENSTD355	14"	355,6	9,52	279	std	60,00	
TEENSTD406	16"	406,4	9,52	305	std	75,00	
TEENSTD457	18"	457,2	9,52	343	std	105,00	
TEENSTD508	20"	508,0	9,52	381	std	125,00	
TEENSTD609	24"	609,6	9,52	432	std	185,00	

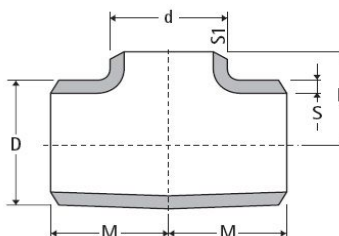

TEE RIDOTTI SCHEDULA STD MATERIALE : WPB ASTM A-234

CODICE	D	d	S	S1	L	schedula	kg	PREZZO €
TEERSTD3326	1"	3/4"	3,38	2,87	38,1	std / sch 40	0,36	
TEERSTD3321	1"	1/2"	3,38	2,87	38,1	std / sch 40	0,36	
TEERSTD4233	1"1/4	1"	3,56	3,38	47,6	std / sch 40	0,50	
TEERSTD4226	1"1/4	3/4"	3,56	2,87	47,6	std / sch 40	0,50	
TEERSTD4221	1"1/4	1/2"	3,56	2,77	47,6	std / sch 40	0,50	
TEERSTD4842	1"1/2	1"1/4	3,68	3,56	57,1	std / sch 40	0,70	
TEERSTD4833	1"1/2	1"	3,68	3,38	57,1	std / sch 40	0,70	
TEERSTD4826	1"1/2	3/4"	3,68	2,87	57,1	std / sch 40	0,70	
TEERSTD4821	1"1/2	1/2"	3,68	2,77	57,1	std / sch 40	0,70	
TEERSTD6048	2"	1"1/2	3,91	3,68	60,3	std / sch 40	1,00	
TEERSTD6042	2"	1"1/4	3,91	3,56	54,2	std / sch 40	1,00	
TEERSTD6033	2"	1"	3,91	3,38	50,8	std / sch 40	1,00	
TEERSTD6026	2"	3/4"	3,91	2,87	44,5	std / sch 40	1,00	

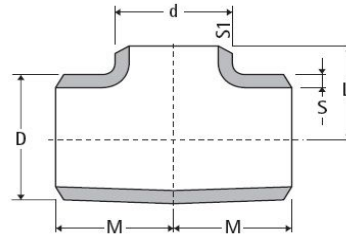

TEE RIDOTTI SCHEDULA STD MATERIALE : WPB ASTM A-234

CODICE	D	d	S	S1	L	M	schedula	kg	PREZZO €
TEERSTD7360	2"1/2	2"	5,16	3,91	69,9		std / sch 40	1,8	
TEERSTD7348	2"1/2	1"1/2	5,16	3,68	66,7		std / sch 40	1,8	
TEERSTD7342	2"1/2	1"1/4	5,16	3,56	63,5		std / sch 40	1,8	
TEERSTD7333	2"1/2	1"	5,16	3,38	54,2		std / sch 40	1,8	
TEERSTD8873	3"	2"1/2	5,49	5,16	82,6		std / sch 40	2,7	
TEERSTD8860	3"	2"	5,49	3,91	76,2		std / sch 40	2,7	
TEERSTD8848	3"	1"1/2	5,49	3,68	79,0		std / sch 40	2,7	
TEERSTD8842	3"	1"1/4	5,49	3,56	69,9		std / sch 40	2,7	
TEERSTD11488	4"	3"	6,02	5,49	98,4		std / sch 40	4,4	
TEERSTD11473	4"	2"1/2	6,02	5,16	95,2		std / sch 40	4,4	
TEERSTD11460	4"	2"	6,02	3,91	88,9		std / sch 40	4,4	
TEERSTD11448	4"	1"1/2	6,02	3,68	85,7		std / sch 40	4,4	
TEERSTD141114	5"	4"	6,55	6,02	117,4		std / sch 40	7,0	
TEERSTD14188	5"	3"	6,55	5,49	111,1		std / sch 40	7,0	
TEERSTD14173	5"	2"1/2	6,55	5,16	107,9		std / sch 40	7,0	
TEERSTD14160	5"	2"	6,55	3,91	104,7		std / sch 40	7,0	
TEERSTD168141	6"	5"	7,11	6,55	136,5		std / sch 40	10,0	
TEERSTD168114	6"	4"	7,11	6,02	130,1		std / sch 40	10,0	
TEERSTD16888	6"	3"	7,11	5,49	123,8		std / sch 40	10,0	
TEERSTD16873	6"	2"1/2	7,11	5,16	120,6		std / sch 40	10,0	
TEERSTD219168	8"	6"	8,18	7,11	168,2		std / sch 40	19,0	
TEERSTD219141	8"	5"	8,18	6,55	161,9		std / sch 40	19,0	
TEERSTD219114	8"	4"	8,18	6,02	155,5		std / sch 40	19,0	
TEERSTD21988	8"	3"	8,18	5,49	150,8		std / sch 40	19,0	
TEERSTD273219	10"	8"	9,27	8,18	203,2		std / sch 40	30,0	
TEERSTD273168	10"	6"	9,27	7,11	193,7		std / sch 40	30,0	
TEERSTD273141	10"	5"	9,27	6,55	190,5		std / sch 40	30,0	
TEERSTD273114	10"	4"	9,27	6,02	184,2		std / sch 40	30,0	
TEERSTD323273	12"	10"	9,52	9,27	241,3		std	47,0	
TEERSTD323219	12"	8"	9,52	8,18	228,6		std	47,0	
TEERSTD323168	12"	6"	9,52	7,11	219,1		std	47,0	
TEERSTD323141	12"	5"	9,52	6,55	215,9		std	47,0	
TEERSTD355323	14"	12"	9,52	9,52	269,9		std	60,0	
TEERSTD355273	14"	10"	9,52	9,27	257,2		std	60,0	
TEERSTD355219	14"	8"	9,52	8,28	247,7		std	60,0	
TEERSTD355168	14"	6"	9,52	7,11	238,1		std	60,0	
TEERSTD406355	16"	14"	9,52	9,52	304,9		std	75,0	
TEERSTD406323	16"	12"	9,52	9,52	295,6		std	75,0	
TEERSTD406273	16"	10"	9,52	9,27	282,6		std	75,0	
TEERSTD406219	16"	8"	9,52	8,18	273,1		std	75,0	

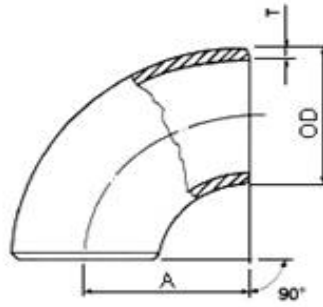

CURVE LONG RADIUS SCHEDULA XS 90° MATERIALE : WPB ASTM A-234

CODICE	Ø	OD mm	T	raggio/A	schedula	Kg x 90°	PREZZO €
CUXS21	1/2"	21,3	3,7		xs/sch80	0,08	
CUXS26	3/4"	26,7	3,9		xs/sch80	0,08	
CUXS33	1"	33,4	4,5		xs/sch80	0,15	
CUXS42	1"1/4	42,2	4,9		xs/sch80	0,26	
CUXS48	1"1/2	48,3	5,1		xs/sch80	0,36	
CUXS60	2"	60,3	5,5		xs/sch80	0,65	
CUXS73	2"1/2	73,0	7,0		xs/sch80	1,30	
CUXS88	3"	88,9	7,6		xs/sch80	2,10	
CUXS114	4"	114,3	8,6		xs/sch80	4,0	
CUXS141	5"	141,3	9,5		xs/sch80	6,7	
CUXS168	6"	168,3	11,0		xs/sch80	10,4	
CUXS219	8"	219,1	12,7		xs/sch80	20,9	
CUXS273	10"	273,0	12,7		xs	37,0	
CUXS323	12"	323,8	12,7		xs	54,0	
CUXS355	14"	355,6	12,7		xs	69,0	
CUXS406	16"	406,4	12,7		xs	90,0	
CUXS457	18"	457,2	12,7		xs	114,0	
CUXS508	20"	508,0	12,7		xs	141,0	
CUXS609	24"	609,6	12,7		xs	203,0	

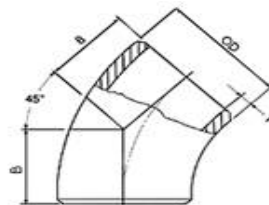

CURVE LONG RADIUS SCHEDULA XS 45° MATERIALE : WPB ASTM A-234

CODICE	Ø	OD/mm	T	schedula	prezzo €
CUXS4533	1"	33,4	4,5	xs/sch80	
CUXS4542	1"1/4	42,2	4,9	xs/sch80	
CUXS4548	1"1/2	48,3	5,1	xs/sch80	
CUXS4560	2"	60,3	5,5	xs/sch80	
CUXS4573	2"1/2	73,0	7,0	xs/sch80	
CUXS4588	3"	88,9	7,6	xs/sch80	
CUXS45101	3"1/2	101,6	8,1	xs/sch80	
CUXS45114	4"	114,3	8,6	xs/sch80	
CUXS45141	5"	141,3	9,5	xs/sch80	
CUXS45168	6"	168,3	11,0	xs/sch80	
CUXS45219	8"	219,1	12,7	xs/sch80	
CUXS45273	10"	273,0	12,7	xs	
CUXS45323	12"	323,8	12,7	xs	

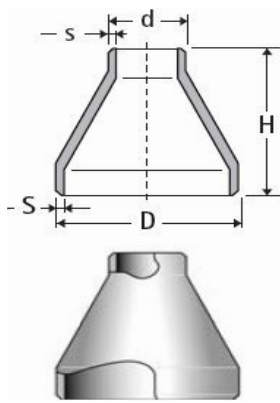

RIDUZIONI CONCENTRICHE SCHEDULA XS MATERIALE : WPB ASTM A-234

CODICE	D	d	S	s	H	PREZZO €
RCXS3326	1"	x 3/4"			50	
RCXS3321	1"	x 1/2"			50	
RCXS4233	1"1/4	x 1"			50	
RCXS4226	1"1/4	x 3/4"			50	
RCXS4221	1"1/4	x 1/2"			50	
RCXS4842	1"1/2	x 1"1/4			64	
RCXS4833	1"1/2	x 1"			64	
RCXS4826	1"1/2	x 3/4"			64	
RCXS4821	1"1/2	x 1/2"			64	
RCXS6048	2"	x 1"1/2			76	
RCXS6042	2"	x 1"1/4			76	
RCXS6033	2"	x 1"			76	
RCXS6026	2"	x 3/4"			76	
RCXS7360	2"1/2	x 2"			90	
RCXS7348	2"1/2	x 1"1/2			90	
RCXS7342	2"1/2	x 1"1/4			90	
RCXS7333	2"1/2	x 1"			90	
RCXS8873	3"	x 2"1/2			90	
RCXS8860	3"	x 2"			90	
RCXS8848	3"	x 1"1/2			90	
RCXS8842	3"	x 1"1/4			90	
RCXS11488	4"	x 3"			100	
RCXS11473	4"	x 2"1/2			100	
RCXS11460	4"	x 2"			100	
RCXS11448	4"	x 1"1/2			100	
RCXS141114	5"	x 4"			127	
RCXS14188	5"	x 3"			127	
RCXS14173	5"	x 2"1/2			127	
RCXS14160	5"	x 2"			127	
RCXS168141	6"	x 5"			140	
RCXS168114	6"	x 4"			140	
RCXS16888	6"	x 3"			140	
RCXS16873	6"	x 2"1/2			140	
RCXS219168	8"	x 6"			152	
RCXS219141	8"	x 5"			152	
RCXS219114	8"	x 4"			152	
RCXS21988	8"	x 3"			152	
RCXS273219	10"	x 8"			178	
RCXS273168	10"	x 6"			178	
RCXS273141	10"	x 5"			178	
RCXS273114	10"	x 4"			178	
RCXS323273	12"	x 10"			203	
RCXS323219	12"	x 8"			203	
RCXS323168	12"	x 6"			203	
RCXS323141	12"	x 5"			203	

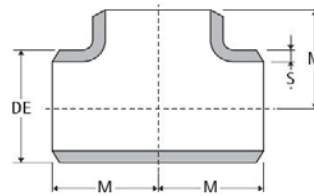

TEE NORMALI SCHEDULA XS MATERIALE : WPB ASTM A-234

CODICE	Ø	DE mm	S	M	schedula	PREZZO €
TEENXS21	1/2"	21,3	3,7	25	xs/sch80	
TEENXS26	3/4"	26,7	3,9	30	xs/sch80	
TEENXS33	1"	33,4	4,5	38	xs/sch80	
TEENXS42	1"1/4	42,2	4,9	48	xs/sch80	
TEENXS48	1"1/2	48,3	5,1	57	xs/sch80	
TEENXS60	2"	60,3	5,5	64	xs/sch80	
TEENXS73	2"1/2	73,0	7,0	76	xs/sch80	
TEENXS88	3"	88,9	7,6	86	xs/sch80	
TEENXS101	3"1/2	101,6	8,1	95	xs/sch80	
TEENXS114	4"	114,3	8,6	105	xs/sch80	
TEENXS141	5"	141,3	9,5	124	xs/sch80	
TEENXS168	6"	168,3	11,0	143	xs/sch80	
TEENXS219	8"	219,1	12,7	178	xs/sch80	
TEENXS273	10"	273,0	12,7	216	xs	
TEENXS323	12"	323,8	12,7	254	xs	

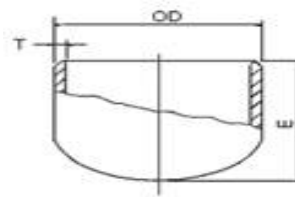

FONDI BOMBATI SCHEDULA XS MATERIALE : WPB ASTM A-234

CODICE	Ø	OD/mm	T	schedula	PREZZO €
FOXS21	1/2"	21,3	3,7	xs/sch80	
FOXS26	3/4"	26,7	3,9	xs/sch80	
FOXS33	1"	33,4	4,5	xs/sch80	
FOXS42	1"1/4	42,2	4,9	xs/sch80	
FOXS48	1"1/2	48,3	5,1	xs/sch80	
FOXS60	2"	60,3	5,5	xs/sch80	
FOXS73	2"1/2	73,0	7,0	xs/sch80	
FOXS88	3"	88,9	7,6	xs/sch80	
FOXS101	3"1/2	101,6	8,1	xs/sch80	
FOXS114	4"	114,3	8,6	xs/sch80	
FOXS141	5"	141,3	9,5	xs/sch80	
FOXS168	6"	168,3	11,0	xs/sch80	
FOXS219	8"	219,1	12,7	xs/sch80	
FOXS273	10"	273,0	12,7	xs	
FOXS323	12"	323,8	12,7	xs	

RACCORDI FILETTATI NPT

serie 3000		GOMITI F/F 90°		serie 6000	
CODICE	PREZZO €			CODICE	PREZZO €
3000CU18	1/8"			6000CU18	1/8"
3000CU14	1/4"			6000CU14	1/4"
3000CU38	3/8"			6000CU38	3/8"
3000CU12	1/2"			6000CU12	1/2"
3000CU34	3/4"			6000CU34	3/4"
3000CU1	1"			6000CU1	1"
3000CU114	1"1/4			6000CU114	1"1/4
3000CU112	1"1/2			6000CU112	1"1/2
3000CU2	2"			6000CU2	2"
3000CU212	2"1/2			6000CU212	2"1/2
3000CU3	3"			6000CU3	3"
3000CU4	4"			6000CU4	4"

serie 3000		GOMITI F/F 45°		serie 6000	
CODICE	PREZZO €			CODICE	PREZZO €
3000CU4518	1/8"			6000CU4518	1/8"
3000CU4514	1/4"			6000CU4514	1/4"
3000CU4538	3/8"			6000CU4538	3/8"
3000CU4512	1/2"			6000CU4512	1/2"
3000CU4534	3/4"			6000CU4534	3/4"
3000CU451	1"			6000CU451	1"
3000CU45114	1"1/4			6000CU45114	1"1/4
3000CU45112	1"1/2			6000CU45112	1"1/2
3000CU452	2"			6000CU452	2"
3000CU45212	2"1/2			6000CU45212	2"1/2
3000CU453	3"			6000CU453	3"
3000CU454	4"			6000CU454	4"

serie 3000		TEE		serie 6000	
CODICE	PREZZO €			CODICE	PREZZO €
3000TEEN18	1/8"			6000TEEN18	1/8"
3000TEEN14	1/4"			6000TEEN14	1/4"
3000TEEN38	3/8"			6000TEEN38	3/8"
3000TEEN12	1/2"			6000TEEN12	1/2"
3000TEEN34	3/4"			6000TEEN34	3/4"
3000TEEN1	1"			6000TEEN1	1"
3000TEEN114	1"1/4			6000TEEN114	1"1/4
3000TEEN112	1"1/2			6000TEEN112	1"1/2
3000TEEN2	2"			6000TEEN2	2"
3000TEEN212	2"1/2			6000TEEN212	2"1/2
3000TEEN3	3"			6000TEEN3	3"
3000TEEN4	4"			6000TEEN4	4"

serie 3000		GOMITO M/F	
CODICE	PREZZO €		
3000CUMF18	1/8"		
3000CUMF14	1/4"		
3000CUMF38	3/8"		
3000CUMF12	1/2"		
3000CUMF34	3/4"		
3000CUMF1	1"		
3000CUMF114	1"1/4		
3000CUMF112	1"1/2		
3000CUMF2	2"		

RACCORDI FILETTATI NPT

serie 3000		CROCI	
CODICE	PREZZO €		
3000CR18	1/8"		
3000CR14	1/4"		
3000CR38	3/8"		
3000CR12	1/2"		
3000CR34	3/4"		
3000CR1	1"		
3000CR114	1"1/4"		
3000CR112	1"1/2"		
3000CR2	2"		
3000CR212	2"1/2"		
3000CR3	3"		
3000CR4	4"		

serie 3000		MANICOTTI		serie 6000	
CODICE	PREZZO €			CODICE	PREZZO €
3000MA18	1/8"			6000MA18	1/8"
3000MA14	1/4"			6000MA14	1/4"
3000MA38	3/8"			6000MA38	3/8"
3000MA12	1/2"			6000MA12	1/2"
3000MA34	3/4"			6000MA34	3/4"
3000MA1	1"			6000MA1	1"
3000MA114	1"1/4"			6000MA114	1"1/4"
3000MA112	1"1/2"			6000MA112	1"1/2"
3000MA2	2"			6000MA2	2"
3000MA212	2"1/2"			6000MA212	2"1/2"
3000MA3	3"			6000MA3	3"
3000MA4	4"			6000MA4	4"

serie 3000		MEZZI MANICOTTI		serie 6000	
CODICE	PREZZO €			CODICE	PREZZO €
3000MM18	1/8"			6000MM18	1/8"
3000MM14	1/4"			6000MM14	1/4"
3000MM38	3/8"			6000MM38	3/8"
3000MM12	1/2"			6000MM12	1/2"
3000MM34	3/4"			6000MM34	3/4"
3000MM1	1"			6000MM1	1"
3000MM114	1"1/4"			6000MM114	1"1/4"
3000MM112	1"1/2"			6000MM112	1"1/2"
3000MM2	2"			6000MM2	2"
3000MM212	2"1/2"			6000MM212	2"1/2"
3000MM3	3"			6000MM3	3"
3000MM4	4"			6000MM4	4"

RACCORDI FILETTATI NPT

serie 3000		TAPPI FEMMINA	serie 6000	
CODICE	PREZZO €		CODICE	PREZZO €
3000TF18	1/8"		6000TF18	1/8"
3000TF14	1/4"		6000TF14	1/4"
3000TF38	3/8"		6000TF38	3/8"
3000TF12	1/2"		6000TF12	1/2"
3000TF34	3/4"		6000TF34	3/4"
3000TF1	1"		6000TF1	1"
3000TF114	1"1/4"		6000TF114	1"1/4"
3000TF112	1"1/2"		6000TF112	1"1/2"
3000TF2	2"		6000TF2	2"
3000TF212	2"1/2"		6000TF212	2"1/2"
3000TF3	3"		6000TF3	3"
3000TF4	4"		6000TF4	4"

serie 3000		TAPPI MASCHIO T.ESAGONALE
CODICE	PREZZO €	
3000TMTE18	1/8"	
3000TMTE14	1/4"	
3000TMTE38	3/8"	
3000TMTE12	1/2"	
3000TMTE34	3/4"	
3000TMTE1	1"	
3000TMTE114	1"1/4"	
3000TMTE112	1"1/2"	
3000TMTE2	2"	
3000TMTE212	2"1/2"	
3000TMTE3	3"	
3000TMTE4	4"	

serie 3000		TAPPI MASCHIO T.TONDA
CODICE	PREZZO €	
3000MTT18	1/8"	
3000MTT14	1/4"	
3000MTT38	3/8"	
3000MTT12	1/2"	
3000MTT34	3/4"	
3000MTT1	1"	
3000MTT114	1"1/4"	
3000MTT112	1"1/2"	
3000MTT2	2"	
3000MTT212	2"1/2"	
3000MTT3	3"	
3000MTT4	4"	

RACCORDI FILETTATI NPT

serie 3000 **TAPPI MASCHIO T.QUADRA**

CODICE	serie 3000	PREZZO €
3000TMTQ18	1/8"	
3000TMTQ14	1/4"	
3000TMTQ38	3/8"	
3000TMTQ12	1/2"	
3000TMTQ34	3/4"	
3000TMTQ1	1"	
3000TMTQ114	1"1/4	
3000TMTQ112	1"1/2	
3000TMTQ2	2"	
3000TMTQ212	2"1/2	
3000TMTQ3	3"	
3000TMTQ4	4"	



serie 3000		PREZZO €	NIPPLI ESAGONALI	serie 6000	
CODICE	CODICE			PREZZO €	
3000NE18	1/8"		6000NE18	1/8"	
3000NE14	1/4"		6000NE14	1/4"	
3000NE38	3/8"		6000NE38	3/8"	
3000NE12	1/2"		6000NE12	1/2"	
3000NE34	3/4"		6000NE34	3/4"	
3000NE1	1"		6000NE1	1"	
3000NE114	1"1/4		6000NE114	1"1/4	
3000NE112	1"1/2		6000NE112	1"1/2	
3000NE2	2"		6000NE2	2"	
3000NE212	2"1/2		6000NE212	2"1/2	
3000NE3	3"		6000NE3	3"	
3000NE4	4"		6000NE4	4"	



SCHEDULA STD/40		PREZZO €	TRONCHETTO FILETTATO NPT / GAS L= 100	SCHEDULA XS/80	
CODICE	CODICE			PREZZO €	
TRSTD38	3/8"		TRXS38	3/8"	
TRSTD12	1/2"		TRXS12	1/2"	
TRSTD34	3/4"		TRXS34	3/4"	
TRSTD1	1"		TRXS1	1"	
TRSTD114	1"1/4		TRXS114	1"1/4	
TRSTD112	1"1/2		TRXS112	1"1/2	
TRSTD2	2"		TRXS2	2"	
TRSTD212	2"1/2		TRXS212	2"1/2	
TRSTD3	3"		TRXS3	3"	
TRSTD4	4"		TRXS4	4"	



SCHEDULA STD/40		PREZZO €	NIPPLO FILETTATO NPT / GAS L= 100	SCHEDULA XS/80	
CODICE	CODICE			PREZZO €	
BNSTD38	3/8"		BNXS38	3/8"	
BNSTD12	1/2"		BNXS12	1/2"	
BNSTD34	3/4"		BNXS34	3/4"	
BNSTD1	1"		BNXS1	1"	
BNSTD114	1"1/4		BNXS114	1"1/4	
BNSTD112	1"1/2		BNXS112	1"1/2	
BNSTD2	2"		BNXS2	2"	
BNSTD212	2"1/2		BNXS212	2"1/2	
BNSTD3	3"		BNXS3	3"	
BNSTD4	4"		BNXS4	4"	



SCHEDULA XS/80

NIPPLO A BOTTIGLIA NPT

CODICE	PREZZO €		CODICE	PREZZO €
3000NB3814	3/8"x1/4"		3000NB2112	2"x1"1/2"
3000NB1238	1/2"x3/8"		3000NB2114	2"x1"1/4"
3000NB1214	1/2"x1/4"		3000NB21	2"x1"
3000NB3412	3/4"x1/2"		3000NB2122	2"1/2x2"
3000NB3438	3/4"x3/8"		3000NB212112	2"1/2x1"1/2"
3000NB134	1"x3/4"		3000NB212114	2"1/2x1"1/4"
3000NB112	1"x1/2"		3000NB3212	3"x2"1/2"
3000NB1141	1"1/4x1"		3000NB32	3"x2"
3000NB11434	1"1/4x3/4"		3000NB3112	3"x1"1/2"
3000NB11412	1"1/4x1/2"		3000NB43	4"x3"
3000NB112114	1"1/2x1"1/4"		3000NB4212	4"x2"1/2"
3000NB1121	1"1/2"x1"		3000NB42	4"x2"
3000NB11234	1"1/2x3/4"			

RACCORDI FILETTATI NPT

RIDUZIONI ESAGONALI

CODICE	PREZZO €		CODICE	PREZZO €
3000RE3814	3/8"x1/4"		3000RE2112	2"x1"1/2"
3000RE1238	1/2"x3/8"		3000RE2114	2"x1"1/4"
3000RE1214	1/2"x1/4"		3000RE21	2"x1"
3000RE3412	3/4"x1/2"		3000RE2122	2"1/2x2"
3000RE3438	3/4"x3/8"		3000RE212112	2"1/2x1"1/2"
3000RE134	1"x3/4"		3000RE212114	2"1/2x1"1/4"
3000RE112	1"x1/2"		3000RE3212	3"x2"1/2"
3000RE1141	1"1/4x1"		3000RE32	3"x2"
3000RE11434	1"1/4x3/4"		3000RE3112	3"x1"1/2"
3000RE11412	1"1/4x1/2"		3000RE43	4"x3"
3000RE112114	1"1/2x1"1/4"		3000RE4212	4"x2"1/2"
3000RE1121	1"1/2"x1"		3000RE42	4"x2"
3000RE11234	1"1/2x3/4"			

serie 3000

BOCCHETTONI F/F

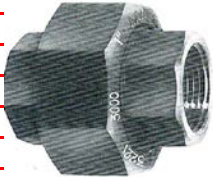
CODICE	PREZZO €	
3000BFF18	1/8"	
3000BFF14	1/4"	
3000BFF38	3/8"	
3000BFF12	1/2"	
3000BFF34	3/4"	
3000BFF1	1"	
3000BFF114	1"1/4"	
3000BFF112	1"1/2"	
3000BFF2	2"	
3000BFF212	2"1/2"	
3000BFF3	3"	
3000BFF4	4"	

serie 3000

BOCCHETTONI M/F

CODICE	prezzo €	
3000BMF18	1/8"	
3000BMF14	1/4"	
3000BMF38	3/8"	
3000BMF12	1/2"	
3000BMF34	3/4"	
3000BMF1	1"	
3000BMF114	1"1/4"	
3000BMF112	1"1/2"	
3000BMF2	2"	

RACCORDI A TASCA

serie 3000		GOMITI A 90°	serie 6000	
CODICE	PREZZO €		CODICE	PREZZO €
3000CUSW18	1/8"		6000CUSW18	1/8"
3000CUSW14	1/4"		6000CUSW14	1/4"
3000CUSW38	3/8"		6000CUSW38	3/8"
3000CUSW12	1/2"		6000CUSW12	1/2"
3000CUSW34	3/4"		6000CUSW34	3/4"
3000CUSW1	1"		6000CUSW1	1"
3000CUSW114	1"1/4		6000CUSW114	1"1/4
3000CUSW112	1"1/2		6000CUSW112	1"1/2
3000CUSW2	2"		6000CUSW2	2"
3000CUSW212	2"1/2		6000CUSW212	2"1/2
3000CUSW3	3"		6000CUSW3	3"
3000CUSW4	4"		6000CUSW4	4"

serie 3000		GOMITI A 45°	serie 6000	
CODICE	PREZZO €		CODICE	PREZZO €
3000CU45SW18	1/8"		6000CU45SW18	1/8"
3000CU45SW14	1/4"		6000CU45SW14	1/4"
3000CU45SW38	3/8"		6000CU45SW38	3/8"
3000CU45SW12	1/2"		6000CU45SW12	1/2"
3000CU45SW34	3/4"		6000CU45SW34	3/4"
3000CU45SW1	1"		6000CU45SW1	1"
3000CU45SW114	1"1/4		6000CU45SW114	1"1/4
3000CU45SW112	1"1/2		6000CU45SW112	1"1/2
3000CU45SW2	2"		6000CU45SW2	2"
3000CU45SW212	2"1/2		6000CU45SW212	2"1/2
3000CU45SW3	3"		6000CU45SW3	3"
3000CU45SW4	4"		6000CU45SW4	4"

serie 3000		TEE	serie 6000	
CODICE	PREZZO €		CODICE	PREZZO €
3000TEENSW18	1/8"		6000TEENSW18	1/8"
3000TEENSW14	1/4"		6000TEENSW14	1/4"
3000TEENSW38	3/8"		6000TEENSW38	3/8"
3000TEENSW12	1/2"		6000TEENSW12	1/2"
3000TEENSW34	3/4"		6000TEENSW34	3/4"
3000TEENSW1	1"		6000TEENSW1	1"
3000TEENSW114	1"1/4		6000TEENSW114	1"1/4
3000TEENSW112	1"1/2		6000TEENSW112	1"1/2
3000TEENSW2	2"		6000TEENSW2	2"
3000TEENSW212	2"1/2		6000TEENSW212	2"1/2
3000TEENSW3	3"		6000TEENSW3	3"
3000TEENSW4	4"		6000TEENSW4	4"

serie 3000		CROCI	serie 6000	
CODICE	PREZZO €		CODICE	PREZZO €
3000CRSW18	1/8"		6000CRSW18	1/8"
3000CRSW14	1/4"		6000CRSW14	1/4"
3000CRSW38	3/8"		6000CRSW38	3/8"
3000CRSW12	1/2"		6000CRSW12	1/2"
3000CRSW34	3/4"		6000CRSW34	3/4"
3000CRSW1	1"		6000CRSW1	1"
3000CRSW114	1"1/4		6000CRSW114	1"1/4
3000CRSW112	1"1/2		6000CRSW112	1"1/2
3000CRSW2	2"		6000CRSW2	2"
3000CRSW212	2"1/2		6000CRSW212	2"1/2
3000CRSW3	3"		6000CRSW3	3"
3000CRSW4	4"		6000CRSW4	4"

RACCORDI A TASCA

serie 3000		MANICOTTI	serie 6000	
CODICE	PREZZO €		CODICE	PREZZO €
3000MASW18	1/8"		6000MASW18	1/8"
3000MASW14	1/4"		6000MASW14	1/4"
3000MASW38	3/8"		6000MASW38	3/8"
3000MASW12	1/2"		6000MASW12	1/2"
3000MASW34	3/4"		6000MASW34	3/4"
3000MASW1	1"		6000MASW1	1"
3000MASW114	1"1/4		6000MASW114	1"1/4
3000MASW112	1"1/2		6000MASW112	1"1/2
3000MASW2	2"		6000MASW2	2"
3000MASW212	2"1/2		6000MASW212	2"1/2
3000MASW3	3"		6000MASW3	3"
3000MASW4	4"		6000MASW4	4"

serie 3000		MEZZI MANICOTTI	serie 6000	
CODICE	PREZZO €		CODICE	PREZZO €
3000MMSW18	1/8"		6000MMSW18	1/8"
3000MMSW14	1/4"		6000MMSW14	1/4"
3000MMSW38	3/8"		6000MMSW38	3/8"
3000MMSW12	1/2"		6000MMSW12	1/2"
3000MMSW34	3/4"		6000MMSW34	3/4"
3000MMSW1	1"		6000MMSW1	1"
3000MMSW114	1"1/4		6000MMSW114	1"1/4
3000MMSW112	1"1/2		6000MMSW112	1"1/2
3000MMSW2	2"		6000MMSW2	2"
3000MMSW212	2"1/2		6000MMSW212	2"1/2
3000MMSW3	3"		6000MMSW3	3"
3000MMSW4	4"		6000MMSW4	4"

serie 3000		MANICOTTI RIDOTTI	serie 6000	
CODICE	PREZZO €		CODICE	PREZZO €
3000MRSW3814	3/8"X1/4"		6000MRSW3814	3/8"X1/4"
3000MRSW3818	3/8"X1/8"		6000MRSW3818	3/8"X1/8"
3000MRSW1238	1/2"X3/8"		6000MRSW1238	1/2"X3/8"
3000MRSW1214	1/2"X1/4"		6000MRSW1214	1/2"X1/4"
3000MRSW3412	3/4"X1/2"		6000MRSW3412	3/4"X1/2"
3000MRSW3438	3/4"X3/8"		6000MRSW3438	3/4"X3/8"
3000MRSW134	1"X3/4"		6000MRSW134	1"X3/4"
3000MRSW112	1"X1/2"		6000MRSW112	1"X1/2"
3000MRSW1141	1"1/4X1"		6000MRSW1141	1"1/4X1"
3000MRSW11434	1"1/4X3/4"		6000MRSW11434	1"1/4X3/4"
3000MRSW112114	1"1/2"X1"1/4		6000MRSW112114	1"1/2"X1"1/4
3000MRSW1121	1"1/2X1"		6000MRSW1121	1"1/2X1"
3000MRSW2112	2"X1"1/2		6000MRSW2112	2"X1"1/2
3000MRSW2114	2"X1"1/4		6000MRSW2114	2"X1"1/4
3000MRSW2122	2"1/2X22		6000MRSW2122	2"1/2X22
3000MRSW212112	2"1/2X1"1/2		6000MRSW212112	2"1/2X1"1/2
3000MRSW3212	3"X2"1/2		6000MRSW3212	3"X2"1/2
3000MRSW32	3"X2"		6000MRSW32	3"X2"

RACCORDI A TASCA

serie 3000		TAPPI TESTA TONDA	serie 6000	
CODICE	PREZZO €		CODICE	PREZZO €
3000TTTSW18	1/8"		6000TTTSW18	1/8"
3000TTTSW14	1/4"		6000TTTSW14	1/4"
3000TTTSW38	3/8"		6000TTTSW38	3/8"
3000TTTSW12	1/2"		6000TTTSW12	1/2"
3000TTTSW34	3/4"		6000TTTSW34	3/4"
3000TTTSW1	1"		6000TTTSW1	1"
3000TTTSW114	1"1/4		6000TTTSW114	1"1/4
3000TTTSW112	1"1/2		6000TTTSW112	1"1/2
3000TTTSW2	2"		6000TTTSW2	2"
3000TTTSW212	2"1/2		6000TTTSW212	2"1/2
3000TTTSW3	3"		6000TTTSW3	3"
3000TTTSW4	4"		6000TTTSW4	4"

serie 3000		BOCCHETTONI	serie 6000	
CODICE	PREZZO €		CODICE	PREZZO €
3000BFFSW18	1/8"		6000BFFSW18	1/8"
3000BFFSW14	1/4"		6000BFFSW14	1/4"
3000BFFSW38	3/8"		6000BFFSW38	3/8"
3000BFFSW12	1/2"		6000BFFSW12	1/2"
3000BFFSW34	3/4"		6000BFFSW34	3/4"
3000BFFSW1	1"		6000BFFSW1	1"
3000BFFSW114	1"1/4		6000BFFSW114	1"1/4
3000BFFSW112	1"1/2		6000BFFSW112	1"1/2
3000BFFSW2	2"		6000BFFSW2	2"
3000BFFSW212	2"1/2		6000BFFSW212	2"1/2
3000BFFSW3	3"		6000BFFSW3	3"
3000BFFSW4	4"		6000BFFSW4	4"

serie 3000		BOCCHETTONI M-NPT / F-SW	serie 6000	
CODICE	PREZZO €		CODICE	PREZZO €
3000BMFSW18	1/8"		6000BMFSW18	1/8"
3000BMFSW14	1/4"		6000BMFSW14	1/4"
3000BMFSW38	3/8"		6000BMFSW38	3/8"
3000BMFSW12	1/2"		6000BMFSW12	1/2"
3000BMFSW34	3/4"		6000BMFSW34	3/4"
3000BMFSW1	1"		6000BMFSW1	1"
3000BMFSW114	1"1/4		6000BMFSW114	1"1/4
3000BMFSW112	1"1/2		6000BMFSW112	1"1/2
3000BMFSW2	2"		6000BMFSW2	2"
3000BMFSW212	2"1/2		6000BMFSW212	2"1/2
3000BMFSW3	3"		6000BMFSW3	3"
3000BMFSW4	4"		6000BMFSW4	4"

VALVOLE A FARFALLA MODELLO ECO CON COMANDO A LEVA



Wafer				Lug			
CODICE	DN	PN	PREZZO €	CODICE	DN	PN	PREZZO €
VW1E50	50	16		VL1E50	50	16	
VW1E65	65	16		VL1E65	65	16	
VW1E80	80	16		VL1E80	80	16	
VW1E100	100	16		VL1E100	100	16	
VW1E125	125	16		VL1E125	125	16	
VW1E150	150	16		VL1150E	150	16	
VW1E200	200	16		VL1E20010	200	10	
				VL1E200	200	16	

Caratteristiche tecniche

Pressione nominale PN16
 Scartamento secondo le norme DIN 3202-K1
 Basamento di raccordo conforme EN ISO 5211
 Corpo versione LUG e WAFER
 raccordabile PN 10/16

- 1 CORPO - Ghisa grigia rivestimento Epoxy BODY - Cast iron Epoxy coated
- 2 DISCO - Ghisa sferoidale placcata Nickel
- 3 SPINETTA - SS416
- 4 MANICOTTO - EPDM SEAT - EPDM
- 5 ASSE - SS410
- 6 BOCCOLA - PTFE BUSHING - PTFE
- 7 O-RING - EPDM O-RING - EPDM

valvole a farfalla

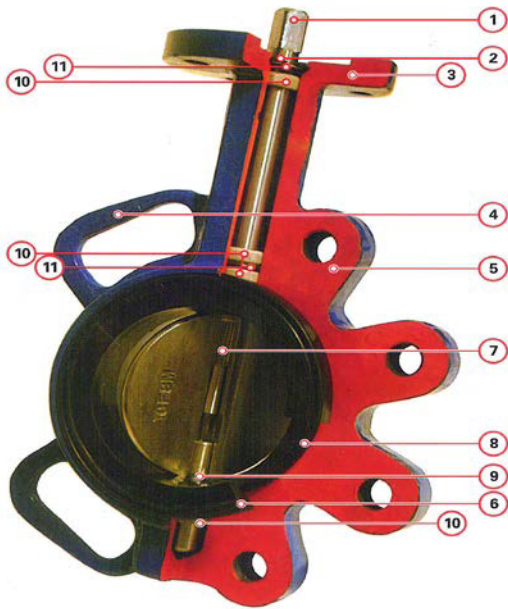

- 1 quadro e base di raccordo per accoppiamento a sistemi automatici di manovra
- 2 sistema antiespulsione dell'asse
- 3 basamento di raccordo en/iso 5211
- 4 visione corpo versione wafer
- 5 visione corpo versione lug
- 6 manicotto di tenuta a doppio inserto
- 7 lavorazione dell'asse/disco
- 8 scanalatura alloggiamento manicotto
- 9 asse inferiore filettato
- 10 boccia
- 11 o-ring

lista materiali componenti

corpo	ghisa sferoidale 400-15 sg con rivestimento epossidico
asse	acciaio inox
manicotto	epdm per temperature da -20°C a +110°C nbr per temperature da -10°C a +80°C fkm per temperature da -20°C a +200°C
disco	ghisa sferoidale 400-15 sg nichelata acciaio inox 316
leva	alluminio
boccia	ptfe
o-ring	epdm nbr fkm

Prodotto in conformità alla direttiva 97/23/EC

Prova di pressione secondo EN 12666-1

Scartamento secondo le norme iso 5752-20--EN 558-20--api 609 -20

VALVOLE A FARFALLA CON COMANDO A LEVA

corpo in ghisa - lente in ghisa manicotto epdm - asse inox 410							
Wafer				Lug			
CODICE	DN	PN	PREZZO €	CODICE	DN	PN	PREZZO €
VW132	32	16		VL132	32	16	
VW140	40	16		VL140	40	16	
VW150	50	16		VL150	50	16	
VW165	65	16		VL165	65	16	
VW180	80	16		VL180	80	16	
VW1100	100	16		VL1100	100	16	
VW1125	125	16		VL1125	125	16	
VW1150	150	16		VL1150	150	16	
VW1200	200	16		VL120010	200	10	
				VL1200	200	16	



corpo in ghisa - lente in ghisa manicotto nbr - asse inox 410							
Wafer				Lug			
CODICE	DN	PN	PREZZO €	CODICE	DN	PN	PREZZO €
VW232	32	16		VL232	32	16	
VW240	40	16		VL240	40	16	
VW250	50	16		VL250	50	16	
VW265	65	16		VL265	65	16	
VW280	80	16		VL280	80	16	
VW2100	100	16		VL2100	100	16	
VW2125	125	16		VL2125	125	16	
VW2150	150	16		VL2150	150	16	
VW2200	200	16		VL220010	200	10	
				VL2200	200	16	

corpo in ghisa - lente inox manicotto epdm - asse inox 410							
Wafer				Lug			
CODICE	DN	PN	PREZZO €	CODICE	DN	PN	PREZZO €
VW332	32	16		VL332	32	16	
VW340	40	16		VL340	40	16	
VW350	50	16		VL350	50	16	
VW365	65	16		VL365	65	16	
VW380	80	16		VL380	80	16	
VW3100	100	16		VL3100	100	16	
VW3125	125	16		VL3125	125	16	
VW3150	150	16		VL3150	150	16	
VW3200	200	16		VL320010	200	10	
				VL3200	200	16	

corpo in ghisa - lente inox manicotto nbr - asse inox 410							
Wafer				Lug			
	DN	PN	PREZZO €		DN	PN	PREZZO €
VW432	32	16		VL432	32	16	
VW440	40	16		VL440	40	16	
VW450	50	16		VL450	50	16	
VW465	65	16		VL465	65	16	
VW480	80	16		VL480	80	16	
VW4100	100	16		VL4100	100	16	
VW4125	125	16		VL4125	125	16	
VW4150	150	16		VL4150	150	16	
VW4200	200	16		VL420010	200	10	
				VL4200	200	16	

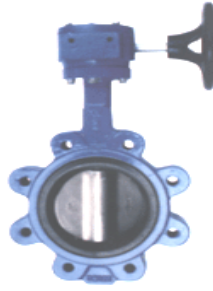

1

VALVOLE A FARFALLA CON RIDUTTORE MANUALE

corpo in ghisa - lente in ghisa manicotto epdm - asse inox 410							
Wafer				Lug			
CODICE	DN	PN	PREZZO €	CODICE	DN	PN	PREZZO €
VW1RM32	32	16		VL1RM32	32	16	
VW1RM40	40	16		VL1RM40	40	16	
VW1RM50	50	16		VL1RM50	50	16	
VW1RM65	65	16		VL1RM65	65	16	
VW1RM80	80	16		VL1RM80	80	16	
VW1RM100	100	16		VL1RM100	100	16	
VW1RM125	125	16		VL1RM125	125	16	
VW1RM150	150	16		VL1RM150	150	16	
VW1RM200	200	10/16		VL1RM20010	200	10	
VW1RM250	250	10/16		VL1RM200	200	16	
VW1RM300	300	10/16		VL1RM25010	250	10	
VW1RM350	350	10/16		VL1RM250	250	16	
VW1RM400	400	10/16		VL1RM30010	300	10	
				VL1RM300	300	16	
				VL1RM35010	350	10	
				VL1RM350	350	16	
				VL1RM40010	400	10	
				VL1RM400	400	16	

corpo in ghisa - lente in ghisa manicotto nbr - asse							
Wafer				Lug			
CODICE	DN	PN	PREZZO €	CODICE	DN	PN	PREZZO €
VW2RM32	32	16		VL2RM32	32	16	
VW2RM40	40	16		VL2RM40	40	16	
VW2RM50	50	16		VL2RM50	50	16	
VW2RM65	65	16		VL2RM65	65	16	
VW2RM80	80	16		VL2RM80	80	16	
VW2RM100	100	16		VL2RM100	100	16	
VW2RM125	125	16		VL2RM125	125	16	
VW2RM150	150	16		VL2RM150	150	16	
VW2RM200	200	10/16		VL2RM20010	200	10	
VW2RM250	250	10/16		VL2RM200	200	16	
VW2RM300	300	10/16		VL2RM25010	250	10	
VW2RM350	350	10/16		VL2RM250	250	16	
VW2RM400	400	10/16		VL2RM30010	300	10	
				VL2RM300	300	16	
				VL2RM35010	350	10	
				VL2RM350	350	16	
				VL2RM40010	400	10	
				VL2RM400	400	16	

VALVOLE A FARFALLA CON RIDUTTORE MANUALE

				corpo in ghisa - lente inox manicotto epdm - asse inox 410									
Wafer								Lug					
CODICE	DN	PN	PREZZO €		CODICE	DN	PN	PREZZO €		CODICE	DN	PN	PREZZO €
VW3RM32	32	16			VL3RM32	32	16						
VW3RM40	40	16			VL3RM40	40	16						
VW3RM50	50	16			VL3RM50	50	16						
VW3RM65	65	16			VL3RM65	65	16						
VW3RM80	80	16			VL3RM80	80	16						
VW3RM100	100	16			VL3RM100	100	16						
VW3RM125	125	16			VL3RM125	125	16						
VW3RM150	150	16			VL3RM150	150	16						
VW3RM200	200	10/16			VL3RM20010	200	10						
VW3RM250	250	10/16			VL3RM200	200	16						
VW3RM300	300	10/16			VL3RM25010	250	10						
VW3RM350	350	10/16			VL3RM250	250	16						
VW3RM400	400	10/16			VL3RM30010	300	10						
					VL3RM300	300	16						
					VL3RM35010	350	10						
					VL3RM350	350	16						
					VL3RM40010	400	10						
					VL3RM400	400	16						

				corpo in ghisa - lente inox manicotto nbr - asse inox 410									
Wafer								Lug					
CODICE	DN	PN	PREZZO €		CODICE	DN	PN	PREZZO €		CODICE	DN	PN	PREZZO €
VW4RM32	32	16			VL4RM32	32	16						
VW4RM40	40	16			VL4RM40	40	16						
VW4RM50	50	16			VL4RM50	50	16						
VW4RM65	65	16			VL4RM65	65	16						
VW4RM80	80	16			VL4RM80	80	16						
VW4RM100	100	16			VL4RM100	100	16						
VW4RM125	125	16			VL4RM125	125	16						
VW4RM150	150	16			VL4RM150	150	16						
VW4RM200	200	10/16			VL4RM20010	200	10						
VW4RM250	250	10/16			VL4RM200	200	16						
VW4RM300	300	10/16			VL4RM25010	250	10						
VW4RM350	350	10/16			VL4RM250	250	16						
VW4RM400	400	10/16			VL4RM30010	300	10						
					VL4RM300	300	16						
					VL4RM35010	350	10						
					VL4RM350	350	16						
					VL4RM40010	400	10						
					VL4RM400	400	16						

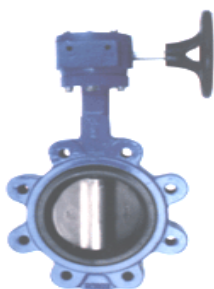



VALVOLE DI RITEGNO FLANGIATA A PALLA

corpo in ghisa - rivestimento epossidico
palla in acciaio rivestita in gomma

CODICE	DN	L	H	PN	PREZZO €
VR150	50	200	106	16	
VR165	65	240	129	16	
VR180	80	260	146	16	
VR1100	100	300	194	16	
VR1125	125	350	207	16	
VR1150	150	400	240	16	
VR1200	200	500	322	10	
VR1250	250	600	388	10	
VR1300	300	700	458	10	

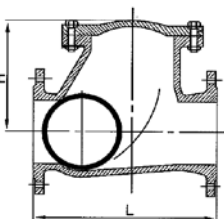

VALVOLE DI RITEGNO DI FONDO PROFILO VENTURI

corpo in ghisa - rivestimento epossidico
molla inox 304-guarnizioni epdm

CODICE	DN	L	D	PN	PREZZO €
VR250	50	100	165	16	
VR265	65	120	185	16	
VR280	80	140	200	16	
VR2100	100	170	220	16	
VR2125	125	200	250	16	
VR2150	150	230	285	16	
VR2200	200	300	340	10	
VR2250	250	370	405	10	

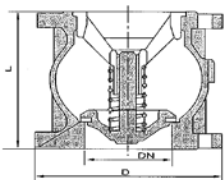

VALVOLE DI RITEGNO FILETTATA A PALLA

corpo in ghisa - rivestimento epossidico
palla in acciaio rivestita in gomma

CODICE	Ø	L	H	PN	PREZZO €
VR525	1"	125	75	16	
VR532	1"1/4	132	75	16	
VR540	1"1/2	145	85	16	
VR550	2"	174	116	16	
VR565	2"1/2	200	116	16	
VR580	3"	243	160	16	

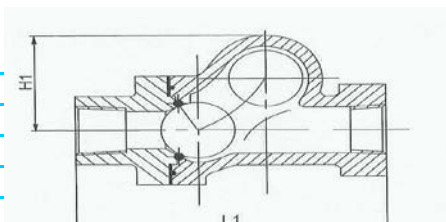



VALVOLE DI RITEGNO A BATTENTE ISPEZIONABILE FLANGIATA

corpo in ghisa - rivestimento epossidico
molla inox 304-guarnizioni epdm

CODICE	DN	L	H	PN	PREZZO €
VR350	50	200	140	10	
VR365	65	240	142	10	
VR380	80	260	165	10	
VR3100	100	300	175	10	
VR3125	125	350	198	10	
VR3150	150	400	228	10	
VR3200	200	500	245	10	
VR3250	250	600	302	10	
VR3300	300	700	365	10	

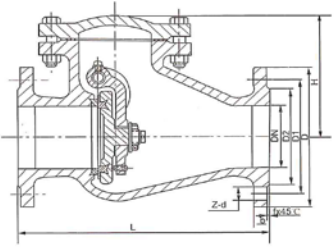

VALVOLE DI RITEGNO A BATTENTE EXTRAPIATTA

corpo e battente in acciaio galvanizzato
guarnizioni in epdm

CODICE	DN	D	E	PN	PREZZO €
VR450	50	109	14	10-16	
VR465	65	129	14	10-16	
VR480	80	144	16	10-16	
VR4100	100	164	18	10-16	
VR4125	125	194	18	10-16	
VR4150	150	220	20	10-16	
VR4200	200	275	22	10-16	
VR4250	250	330	26	10-16	
VR4300	300	380	28	10-16	

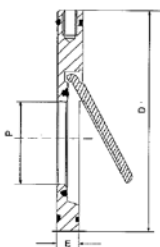

VALVOLE DI RITEGNO A DOPPIO BATTENTE

corpo in ghisa - rivestimento epossidico
battenti inox 316 - guarnizioni fkm

CODICE	DN	A	B	PN	PREZZO €
VR650	50	109	54	10-16	
VR665	65	129	54	10-16	
VR680	80	144	57	10-16	
VR6100	100	164	64	10-16	
VR6125	125	194	70	10-16	
VR6150	150	220	76	10-16	
VR6200	200	275	95	10-16	
VR6250	250	330	108	10-16	
VR6300	300	380	144	10-16	

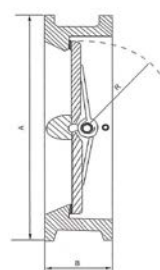



VALVOLE DI RITEGNO A DISCO

corpo e disco in cf8m
molla inox 316 - tenuta molla 316

CODICE	DN	E	L	PN	PREZZO €
VR715	15	43	16	40	
VR720	20	53	19	40	
VR725	25	63	22	40	
VR732	32	75	28	40	
VR740	40	86	32	40	
VR750	50	95	40	40	
VR765	65	115	46	40	
VR780	80	131	50	40	
VR7100	100	151	60	40	

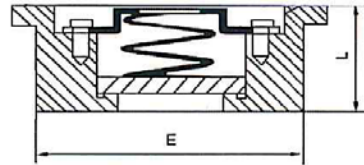

FILTRI A Y

corpo in ghisa - rivestimento epossidico
rete filtro inox

CODICE	DN	L	H	PN	PREZZO €
FY15	15	130	72	16	
FY20	20	150	80	16	
FY25	25	160	90	16	
FY32	32	180	105	16	
FY40	40	200	105	16	
FY50	50	230	170	16	
FY65	65	290	205	16	
FY80	80	310	210	16	
FY100	100	350	235	16	
FY125	125	400	270	16	
FY150	150	480	310	16	
FY20010	200	600	390	10	
FY20016	200	600	390	16	
FY25010	250	730	430	10	
FY25016	250	730	430	16	
FY30010	300	850	500	10	
FY30016	300	850	500	16	
FY35010	350	980	670	10	
FY35016	350	980	670	16	

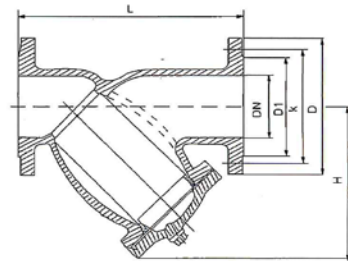



VALVOLE A SARACINESCA CUNEO GOMMATO CORPO PIATTO

corpo in ghisa - rivestimento epossidico

CODICE	Ø	L	H	PN	n.fori	PREZZO €
VS40	40	140	260	16	4	
VS50	50	150	270	16	4	
VS65	65	170	283	16	4	
VS80	80	180	311	16	8	
VS100	100	190	352	16	8	
VS125	125	200	435	16	8	
VS150	150	210	485	16	8	
VS20010	200	230	520	10	8	
VS200	200	230	520	16	12	
VS25010	250	250	635	10	12	
VS250	250	250	635	16	12	
VS30010	300	270	745	10	12	
VS300	300	270	745	16	12	

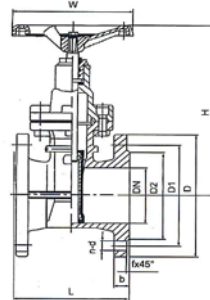

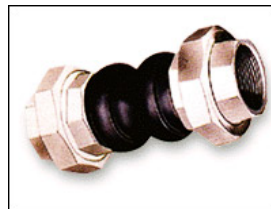

GIUNTI ANTIVIBRANTI FLANGIATI

corpo in ghisa - rivestimento epossidico
molla inox 304-guarnizioni epdm

CODICE	DN	L	PN	PREZZO €
GFL32	32	95	16	
GFL40	40	95	16	
GFL50	50	105	16	
GFL65	65	115	16	
GFL80	80	130	16	
GFL100	100	135	16	
GFL125	125	170	16	
GFL150	150	180	16	
GFL20010	200	205	10	
GFL20016	200	205	16	
GFL25010	250	240	10	
GFL25016	250	240	16	
GFL30010	300	260	10	
GFL30016	300	260	16	
GFL35010	350	265	10	
GFL35016	350	265	16	
GFL40010	400	265	10	
GFL40016	400	265	16	
GFL45010	450	265	10	
GFL45016	450	265	16	
GFL50010	500	265	10	
GFL50016	500	265	16	
GFL60010	600	265	10	
GFL60016	600	265	16	

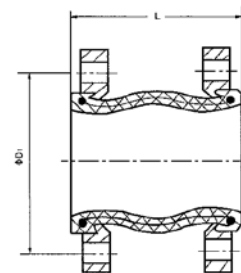

GIUNTI ANTIVIBRANTI FILETTATI

corpo in ghisa - rivestimento epossidico
molla inox 304-guarnizioni epdm

CODICE	Ø	L	PN	PREZZO €
GFI21	1/2"	200	10	
GFI26	3/4"	200	10	
GFI33	1"	200	10	
GFI42	1"1/4	200	10	
GFI48	1"1/2	200	10	
GFI60	2"	200	10	
GFI76	2"1/2	240	10	
GFI88	3"	240	10	

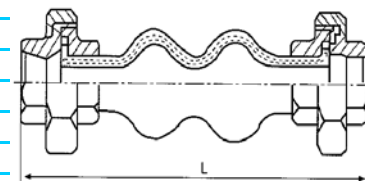

VALVOLA A SFERA IN OTTONE F.F. CON LEVA

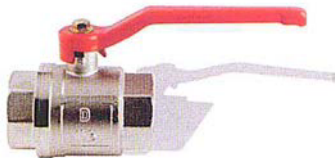
CODICE	Ø MISURA		PREZZO €
VS0138	3/8"		6,63
VS0112	1/2"		7,11
VS0134	3/4"		10,22
VS0111	1"		15,60
VS01114	1"1/4		22,00
VS01112	1"1/2"		35,10
VS012	2"		51,17

VALVOLA A SFERA IN OTTONE M.F. CON LEVA

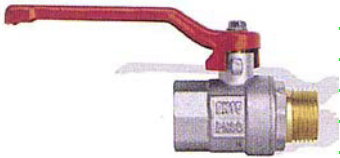
CODICE	Ø MISURA		PREZZO €
VS0238	3/8"		
VS0212	1/2"		
VS0234	3/4"		
VS021	1"		
VS02114	1"1/4		
VS02112	1"1/2"		
VS022	2"		

VALVOLA A SFERA IN OTTONE F.F. CON MANIGLIA A FARFALLA

CODICE	Ø MISURA		PREZZO €
VS0338	3/8"		
VS0312	1/2"		
VS0334	3/4"		
VS031	1"		

VALVOLA A SFERA IN OTTONE M.F. CON MANIGLIA A FARFALLA

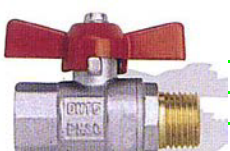
CODICE	Ø MISURA		PREZZO €
VS0438	3/8"		
VS0412	1/2"		
VS0434	3/4"		
VS041	1"		

VALVOLA DI RITEGNO IN OTTONE F.F.

CODICE	Ø MISURA		PREZZO €
VR912	1/2"		
VR934	3/4"		
VR91	1"		
VR9114	1"1/4		
VR9112	1"1/2		
VR92	2"		

VALVOLA DI RITEGNO IN OTTONE M.F.

CODICE	Ø MISURA		PREZZO €
VR1012	1/2"		
VR1034	3/4"		
VR101	1"		
VR10114	1"1/4		
VR10112	1"1/2		
VR102	2"		

VALVOLE MINISFERA IN OTTONE FF

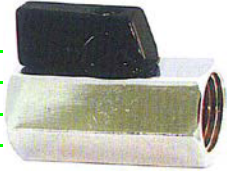
CODICE	Ø MISURA		PREZZO €
VS0518	1/8"		_____
VS0514	1/4"		_____
VS0538	3/8"		_____
VS0512	1/2"		_____
VS0534	3/4"		_____

VALVOLE MINISFERA IN OTTONE MF

CODICE	Ø MISURA		PREZZO €
VS0618	1/8"		_____
VS0614	1/4"		_____
VS0638	3/8"		_____
VS0612	1/2"		_____
VS0634	3/4"		_____

RACCORDI IN ACCIAIO ZINCATO

CODICE	Ø MISURA	MANICOTTO RIDOTTO	F.F.	PREZZO €
240RAC1418	1/4" X 1/8"			
240RAC3818	3/8" X 1/8"			
240RAC3814	3/8" X 1/4"			
240RAC1214	1/2" X 1/4"			
240RAC1238	1/2" X 3/8"			
240RAC3414	3/4" X 1/4"			
240RAC3438	3/4" X 3/8"			
240RAC3412	3/4" X 1/2"			
240RAC138	1" X 3/8"			
240RAC112	1" X 1/2"			
240RAC134	1" X 3/4"			
240RAC1141	1"1/4 X 1"			



CODICE	Ø MISURA	RIDUZIONE ESAGONALE	M.F.	PREZZO €
241AC1418	1/4" X 1/8"			
241AC3818	3/8" X 1/8"			
241AC3814	3/8" X 1/4"			
241AC1218	1/2" X 1/8"			
241AC1214	1/2" X 1/4"			
241AC1238	1/2" X 3/8"			
241AC3414	3/4" X 1/4"			
241AC3438	3/4" X 3/8"			
241AC3412	3/4" X 1/2"			
241AC114	1" X 1/4"			
241AC138	1" X 3/8"			
241AC112	1" X 1/2"			
241AC134	1" X 3/4"			
241AC11412	1"1/4 X 1/2"			
241AC11434	1"1/4 X 3/4"			
241AC1141	1"1/4 X 1"			
241AC11212	1"1/2 X 1/2"			
241AC11234	1"1/2 X 3/4"			
241AC1121	1"1/2 X 1"			
241AC112114	1"1/2 X 1"1/4"			
241AC212	2" X 1/2"			
241AC234	2" X 3/4"			
241AC21	2" X 1"			
241AC2114	2" X 1"1/4"			
241AC2112	2" X 1"1/2"			



CODICE	Ø MISURA	RIDUZIONE PARTICOLARE	PREZZO €
242AC128	1/2" X 8 MA		
242AC1210	1/2" X 10 MA		



RACCORDI IN ACCIAIO ZINCATO

CODICE	Ø MISURA	VITE DOPPIA RIDOTTA	M.M.	PREZZO €
245AC1418	1/4" X 1/8"			
245AC3818	3/8" X 1/8"			
245AC3814	3/8" X 1/4"			
245AC1218	1/2" X 1/8"			
245AC1214	1/2" X 1/4"			
245AC1238	1/2" X 3/8"			
245AC3414	3/4" X 1/4"			
245AC3438	3/4" X 3/8"			
245AC3412	3/4" X 1/2"			
245AC138	1" X 3/8"			
245AC112	1" X 1/2"			
245AC134	1" X 3/4"			
245AC11412	1"1/4 X 1/2"			
245AC11434	1"1/4 X 3/4"			
245AC1141	1"1/4 X 1"			
245AC11212	1"1/2 X 1/2"			
245AC11234	1"1/2 X 3/4"			
245AC1121	1"1/2 X 1"			
245AC112114	1"1/2 X 1"1/4"			
245AC212	2" X 1/2"			
245AC234	2" X 3/4"			
245AC21	2" X 1"			
245AC2114	2" X 1"1/4"			
245AC2112	2" X 1"1/2"			



CODICE	L	Ø MISURA	PROLUNGA RIDOTTA	F.M.	PREZZO €
246AC1418		1/4" X 1/8"			
246AC3814		3/8" X 1/4"			
246AC1214		1/2" X 1/4"			
246AC1238		1/2" X 3/8"			
246AC3438		3/4" X 3/8"			
246AC3412		3/4" X 1/2"			
246AC112		1" X 1/2"			
246AC134		1" X 3/4"			
246AC1141		1"1/4 X 1"			



CODICE	L	Ø MISURA	PROLUNGA RIDOTTA	F.M.	PESANTE	PREZZO €
246AC3814P		3/8" X 1/4"				
246AC1238P		1/2" X 3/8"				



RACCORDI IN ACCIAIO ZINCATO

CODICE	Ø MISURA	VITE DOPPIA	M.M.	PREZZO €
280AC18	1/8"			
280AC14	1/4"			
280AC38	3/8"			
280AC12	1/2"			
280AC34	3/4"			
280AC1	1"			
280AC114	1"1/4			
280AC112	1"1/2			
280AC2	2"			



CODICE	Ø MISURA	VITE DOPPIA	M.M. DESTRA/SINISTRA	PREZZO €
281AC38	3/8"			
281AC12	1/2"			
281AC34	3/4"			
281AC1	1"			



CODICE	Ø MISURA	VITE DOPPIA	M.M. SEDE PIANA	PREZZO €
282AC12	1/2"			



CODICE	Ø MISURA	TAPPO CONICO TESTA QUADRA	PREZZO €
290AC14	1/4"		
290AC38	3/8"		
290AC12	1/2"		
290AC34	3/4"		
290AC1	1"		



CODICE	Ø MISURA	TAPPO TESTA ESAGONALE	PREZZO €
292AC18	1/8"		
292AC14	1/4"		
292AC38	3/8"		
292AC12	1/2"		
292AC34	3/4"		
292AC1	1"		
292AC114	1"1/4		
292AC112	1"1/2		
292AC2	2"		



CODICE	Ø MISURA	CALOTTA ESAGONALE	PREZZO €
300AC18	1/8"		
300AC14	1/4"		
300AC38	3/8"		
300AC12	1/2"		
300AC34	3/4"		
300AC1	1"		
300AC114	1"1/4		
300AC112	1"1/2		



RACCORDI IN ACCIAIO ZINCATO

CODICE	Ø MISURA	PROLUNGA	M.F. CON ESAGONO INTERNO	PREZZO €
529B1210	1/2" X 10			
529B1215	1/2" X 15			
529B1220	1/2" X 20			
529B1225	1/2" X 25			
529B1230	1/2" X 30			



CODICE	Ø MISURA	PROLUNGA	M.F. CON FORO 14,5	PREZZO €
529F1210	1/2" X 10			
529F1215	1/2" X 15			
529F1220	1/2" X 20			
529F1225	1/2" X 25			
529F1230	1/2" X 30			



CODICE	Ø MISURA	PROLUNGA	M.F. PESANTE	PREZZO €
529P3810	3/8" X 10			
529P3815	3/8" X 15			
529P3820	3/8" X 20			
529P3825	3/8" X 25			
529P3830	3/8" X 30			
529P1210	1/2" X 10			
529P1215	1/2" X 15			
529P1220	1/2" X 20			
529P1225	1/2" X 25			
529P1230	1/2" X 30			



CODICE	Ø MISURA	MANICOTTO RIDOTTO	M.F.	PREZZO €
520AC1238	1/2" X 3/8"			
520AC3412	3/4" X 1/2"			
520AC134	1" X 3/4"			



CODICE	Ø MISURA	VITE SEMPLICE CON ESAGONO INTERNO	PREZZO €
531AC18	1/8"		
531AC14	1/4"		
531AC38	3/8"		
531AC12	1/2"		
531AC34	3/4"		
531AC1	1"		



CODICE	Ø MISURA	VITE SEMPLICE SENZA ESAGONO INTERNO	PREZZO €
532AC114	1"1/4		
532AC112	1"1/2		
532AC2	2"		
532AC212	2"1/2		
532AC3	3"		



RACCORDI IN ACCIAIO ZINCATO

CODICE	Ø MISURA	CONTRODADO	PREZZO €
310AC18	1/8"		
310AC14	1/4"		
310AC38	3/8"		
310AC12	1/2"		
310AC34	3/4"		
310AC1	1"		
310AC114	1"1/4		
310AC112	1"1/2		



CODICE	Ø MISURA	PROLUNGA	M.F.	PREZZO €
529AC1415	1/4" X 15			
529AC3810	3/8" X 10			
529AC3815	3/8" X 15			
529AC3820	3/8" X 20			
529AC3825	3/8" X 25			
529AC3830	3/8" X 30			
529AC3835	3/8" X 35			
529AC3840	3/8" X 40			
529AC3850	3/8" X 50			
529AC1210	1/2" X 10			
529AC1215	1/2" X 15			
529AC1220	1/2" X 20			
529AC1225	1/2" X 25			
529AC1230	1/2" X 30			
529AC1235	1/2" X 35			
529AC1240	1/2" X 40			
529AC1250	1/2" X 50			
529AC3410	3/4" X 10			
529AC3415	3/4" X 15			
529AC3420	3/4" X 20			
529AC3425	3/4" X 25			
529AC3430	3/4" X 30			
529AC3435	3/4" X 35			
529AC3440	3/4" X 40			
529AC3450	3/4" X 50			
529AC110	1" X 10			
529AC115	1" X 15			
529AC120	1" X 20			
529AC125	1" X 25			
529AC130	1" X 30			
529AC135	1" X 35			
529AC140	1" X 40			
529AC150	1" X 50			
529AC11410	1"1/4 X 10			
529AC11415	1"1/4 X 15			
529AC11420	1"1/4 X 20			
529AC11425	1"1/4 X 25			
529AC11430	1"1/4 X 30			



RACCORDI IN ACCIAIO ZINCATO

CODICE	Ø MISURA	RACCORDO MASCHIO PER TUBO ANTIVIBRANTE	PREZZO €
533AC12	1/2"		
533AC34	3/4"		
533AC1	1"		
533AC114	1"1/4		
533AC112	1"1/2		
533AC2	2"		



CODICE	Ø MISURA	DADO PER TUBO ANTIVIBRANTE	PREZZO €
534AC12	1/2"		
534AC34	3/4"		
534AC1	1"		
534AC114	1"1/4		
534AC112	1"1/2		
534AC2	2"		



CODICE	Ø MISURA	CODULO SEDE PIANA PER TUBO ANTIVIBRANTE	PREZZO €
535AC12	1/2"		
535AC34	3/4"		
535AC1	1"		
535AC114	1"1/4		
535AC112	1"1/2		
535AC2	2"		



CODICE	Ø MISURA	CODULO SEDE OGIVA PER TUBO ANTIVIBRANTE	PREZZO €
536AC12	1/2"		
536AC34	3/4"		
536AC1	1"		
536AC114	1"1/4		
536AC112	1"1/2		
536AC2	2"		



CODICE	Ø MISURA	VITE DOPPIA M.M. SEDE PIANA E SVASATA	PREZZO €
537AC12	1/2"		
537AC34	3/4"		
537AC1	1"		
537AC114	1"1/4		
537AC112	1"1/2		
537AC2	2"		



RACCORDI IN GHISA MALLEABILE ZINCATA -CUORE BIANCO- EN10242

CODICE	Ø MISURA	CURVA LUNGA 90° M/F	FIG.1	PREZZO €
1GH18	1/8"			
1GH14	1/4"			
1GH38	3/8"			
1GH12	1/2"			
1GH34	3/4"			
1GH1	1"			
1GH114	1"1/4			
1GH112	1"1/2			
1GH2	2"			
1GH212	2"1/2			
1GH3	3"			
1GH4	4"			



CODICE	Ø MISURA	CURVA LUNGA 90° F/F	FIG.2	PREZZO €
2GH14	1/4"			
2GH38	3/8"			
2GH12	1/2"			
2GH34	3/4"			
2GH1	1"			
2GH114	1"1/4			
2GH112	1"1/2			
2GH2	2"			
2GH212	2"1/2			
2GH3	3"			
2GH4	4"			



CODICE	Ø MISURA	CURVA LUNGA 45° M/F	FIG.40	PREZZO €
40GH14	1/4"			
40GH38	3/8"			
40GH12	1/2"			
40GH34	3/4"			
40GH1	1"			
40GH114	1"1/4			
40GH112	1"1/2			
40GH2	2"			
40GH212	2"1/2			
40GH3	3"			
40GH4	4"			



CODICE	Ø MISURA	CURVA LUNGA 45° F/F	FIG.41	PREZZO €
41GH38	3/8"			
41GH12	1/2"			
41GH34	3/4"			
41GH1	1"			
41GH114	1"1/4			
41GH112	1"1/2			
41GH2	2"			
41GH212	2"1/2			
41GH3	3"			
41GH4	4"			



RACCORDI IN GHISA MALLEABILE ZINCATA -CUORE BIANCO- EN10242

CODICE	Ø MISURA	CURVA DI SORPASSO	FIG.85	PREZZO €
85GH38	3/8"			4,89
85GH12	1/2"			3,68
85GH34	3/4"			5,56
85GH1	1"			11,57
85GH114	1"1/4			21,76



CODICE	Ø MISURA	GOMITO 90° F/F	FIG.90	PREZZO €
90GH18	1/8"			
90GH14	1/4"			
90GH38	3/8"			
90GH12	1/2"			
90GH34	3/4"			
90GH1	1"			
90GH114	1"1/4			
90GH112	1"1/2			
90GH2	2"			
90GH212	2"1/2			
90GH3	3"			
90GH4	4"			
90GH5	5"			
90GH6	6"			



CODICE	Ø MISURA	GOMITO RIDOTTO 90° F/F	FIG.90R	PREZZO €
90RGH3814	3/8"X1/4"			
90RGH1214	1/2"X1/4"			
90RGH1238	1/2"X3/8"			
90RGH3438	3/4"X3/8"			
90RGH3412	3/4"X1/2"			
90RGH138	1"X3/8"			
90RGH112	1"X1/2"			
90RGH134	1"X3/4"			
90RGH11412	1"1/4X1/2"			
90RGH11434	1"1/4X3/4"			
90RGH1141	1"1/4X1"			
90RGH11212	1"1/2X1/2"			
90RGH11234	1"1/2X3/4"			
90RGH1121	1"1/2X1"			
90RGH112114	1"1/2X1"1/4"			
90RGH212	2"X1/2"			
90RGH234	2"X3/4"			
90RGH21	2"X1"			
90RGH2114	2"X1"1/4"			
90RGH2112	2"X1"1/2"			
90RGH212112	2"1/2X1"1/2"			
90RGH2122	2"1/2X2"			
90RGH3112	3"X1"1/2"			
90RGH32	3"X2"			
90RGH3212	3"X2"1/2"			



RACCORDI IN GHISA MALLEABILE ZINCATA -CUORE BIANCO- EN10242

CODICE	Ø MISURA	GOMITO 90° MF	FIG.92	PREZZO €
92GH18	1/8"			
92GH14	1/4"			
92GH38	3/8"			
92GH12	1/2"			
92GH34	3/4"			
92GH1	1"			
92GH114	1"1/4			
92GH112	1"1/2			
92GH2	2"			
92GH212	2"1/2			
92GH3	3"			
92GH4	4"			



CODICE	Ø MISURA	GOMITO RIDOTTO 90° MF	FIG.92R	PREZZO €
92RGH1238	1/2"X3/8"			
92RGH3412	3/4"X1/2"			
92RGH112	1"X1/2"			
92RGH134	1"X3/4"			
92RGH1141	1"1/4X1"			



CODICE	Ø MISURA	GOMITO BOCCHETTONE PIANO FF	FIG.95	PREZZO €
95GH38	3/8"			
95GH12	1/2"			
95GH34	3/4"			
95GH1	1"			
95GH114	1"1/4			
95GH112	1"1/2			
95GH2	2"			
95GH212	2"1/2			
95GH3	3"			



CODICE	Ø MISURA	GOMITO BOCCHETTONE CONICO FF	FIG.96	PREZZO €
96GH14	1/4"			
96GH38	3/8"			
96GH12	1/2"			
96GH34	3/4"			
96GH1	1"			
96GH114	1"1/4			
96GH112	1"1/2			
96GH2	2"			
96GH212	2"1/2			
96GH3	3"			



RACCORDI IN GHISA MALLEABILE ZINCATA -CUORE BIANCO- EN10242

CODICE Ø MISURA **GOMITO BOCCHETTONE PIANO MF FIG.97** PREZZO €

97GH38	3/8"
97GH12	1/2"
97GH34	3/4"
97GH1	1"
97GH114	1"1/4
97GH112	1"1/2
97GH2	2"
97GH212	2"1/2
97GH3	3"



CODICE Ø MISURA **GOMITO BOCCHETTONE CONICO MF FIG.98** PREZZO €

98GH14	1/4"
98GH38	3/8"
98GH12	1/2"
98GH34	3/4"
98GH1	1"
98GH114	1"1/4
98GH112	1"1/2
98GH2	2"
98GH212	2"1/2
98GH3	3"



CODICE Ø MISURA **GOMITO 45° FF** **FIG.120** PREZZO €

120GH14	1/4"
120GH38	3/8"
120GH12	1/2"
120GH34	3/4"
120GH1	1"
120GH114	1"1/4
120GH112	1"1/2
120GH2	2"
120GH212	2"1/2
120GH3	3"
120GH4	4"
120GH6	6"



CODICE Ø MISURA **GOMITO 45° MF** **FIG.121** PREZZO €

121GH14	1/4"
121GH38	3/8"
121GH12	1/2"
121GH34	3/4"
121GH1	1"
121GH114	1"1/4
121GH112	1"1/2
121GH2	2"
121GH212	2"1/2
121GH3	3"
121GH4	4"



RACCORDI IN GHISA MALLEABILE ZINCATA -CUORE BIANCO- EN10242

CODICE	Ø MISURA	TEE NORMALE	FIG.130	PREZZO €
130GH18	1/8"			
130GH14	1/4"			
130GH38	3/8"			
130GH12	1/2"			
130GH34	3/4"			
130GH1	1"			
130GH114	1"1/4			
130GH112	1"1/2			
130GH2	2"			
130GH212	2"1/2			
130GH3	3"			
130GH4	4"			
130GH5	5"			
130GH6	6"			



CODICE	Ø MISURA	TEE RIDOTTO	FIG.130	PREZZO €
130RGH381438	3/8"X1/4"X3/8"			
130RGH381238	3/8"X1/2"X3/8"			
130RGH121412	1/2"X1/4"X1/2"			
130RGH123838	1/2"X3/8"X3/8"			
130RGH123812	1/2"X3/8"X1/2"			
130RGH121238	1/2"X1/2"X3/8"			
130RGH123412	1/2"X3/4"X1/2"			
130RGH12112	1/2"X1"X1/2"			
130RGH341434	3/4"X1/4"X3/4"			
130RGH343812	3/4"X3/8"X1/2"			
130RGH343834	3/4"X3/8"X3/4"			
130RGH341238	3/4"X1/2"X3/8"			
130RGH341212	3/4"X1/2"X1/2"			
130RGH341234	3/4"X1/2"X3/4"			
130RGH343438	3/4"X3/4"X3/8"			
130RGH343412	3/4"X3/4"X1/2"			
130RGH34112	3/4"X1"X1/2"			
130RGH34134	3/4"X1"X3/4"			
130RGH1141	1"X1/4"X1"			
130RGH1381	1"X3/8"X1"			
130RGH11212	1"X1/2"X1/2"			
130RGH11234	1"X1/2"X3/4"			
130RGH1121	1"X1/2"X1"			
130RGH13412	1"X3/4"X1/2"			
130RGH13434	1"X3/4"X3/4"			
130RGH1341	1"X3/4"X1"			
130RGH1138	1"X1"X3/8"			
130RGH1112	1"X1"X1/2"			
130RGH1134	1"X1"X3/4"			
130RGH111434	1"X1"1/4X3/4"			
130RGH11141	1"X1"1/4X1"			
130RGH11121	1"X1"1/2X1"			
130RGH11438114	1"1/4X3/8"X1"1/4			
130RGH114121	1"1/4X1/2"X1"			
130RGH11412114	1"1/4X1/2"X1"1/4			
130RGH1143434	1"1/4X3/4"X3/4"			
130RGH114341	1"1/4X3/4"X1"			
130RGH11434114	1"1/4X3/4"X1"1/4			
130RGH114134	1"1/4X1"X3/4"			
130RGH11411	1"1/4X1"X1"			
130RGH1141114	1"1/4X1"X1"1/4			
130RGH11411412	1"1/4X1"1/4X1/2"			



RACCORDI IN GHISA MALLEABILE ZINCATA -CUORE BIANCO- EN10242

CODICE	Ø MISURA	TEE RIDOTTO	FIG.130R	PREZZO €
130RGH11411434	1"1/4X1"1/4X3/4"			
130RGH1141141	1"1/4X1"1/4X1"			
130RGH1141121	1"1/4X1"1/2X1"			
130RGH114112114	1"1/4X1"1/2X1"1/4			
130RGH1142114	1"1/4X2"X1"1/4			
130RGH1121234	1"1/2X1/2"X3/4"			
130RGH11212114	1"1/2X1/2"X1"1/4			
130RGH11238112	1"1/2X3/8"X1"1/2			
130RGH11212112	1"1/2X1/2"X1"1/2			
130RGH11234112	1"1/2X3/4"X1"1/2			
130RGH11234114	1"1/2X3/4"X1"1/4			
130RGH112134	1"1/2"X1"X3/4"			
130RGH11211	1"1/2X1"X1"			
130RGH1121114	1"1/2X1"X1"1/4			
130RGH1121112	1"1/2X1"X1"1/2			
130RGH1121141	1"1/2X1"1/4X1"			
130RGH112114114	1"1/2X1"1/4X1"1/4			
130RGH112114112	1"1/2X1"1/4X1"1/2			
130RGH11211212	1"1/2X1"1/2X1/2"			
130RGH11211234	1"1/2X1"1/2X3/4"			
130RGH1121121	1"1/2X1"1/2X1"			
130RGH112112114	1"1/2X1"1/2X1"1/4			
130RGH1122112	1"1/2X2"X1"1/2			
130RGH1122114	1"1/2X2"X1"1/4			
130RGH212112	2"X1/2"X1"1/2			
130RGH2122	2"X1/2"X2"			
130RGH234112	2"X3/4"X1"1/2			
130RGH2342	2"X3/4"X2"			
130RGH21112	2"X1"X1"1/2			
130RGH212	2"X1"X2"			
130RGH2114114	2"X1"1/4X1"1/4			
130RGH2114112	2"X1"1/4X1"1/2			
130RGH21142	2"X1"1/4X2"			
130RGH2112112	2"X1"1/2X1"1/2			
130RGH21122	2"X1"1/2X2"			
130RGH2212	2"X2"X1/2"			
130RGH2234	2"X2"X3/4"			
130RGH221	2"X2"X1"			
130RGH22114	2"X2"X1"1/4			
130RGH22112	2"X2"X1"1/2			
130RGH22122	2"X2"1/2X2"			
130RGH21212212	2"1/2X1/2"X2"1/2			
130RGH21234212	2"1/2X3/4"X2"1/2			
130RGH2121212	2"1/2X1"X2"1/2			
130RGH212114212	2"1/2X1"1/4X2"1/2			
130RGH212112212	2"1/2X1"1/2X2"1/2			
130RGH21222	2"1/2X2"X2"			
130RGH2122212	2"1/2X"2"X2"1/2			
130RGH212212112	2"1/2X2"1/2X1"1/2			
130RGH2122122	2"1/2X2"1/2X2"			
130RGH3123	3"X1/2"X3"			
130RGH3343	3"X3/4"X3"			
130RGH313	3"X1"X3"			
130RGH31143	3"X1"1/4X3"			
130RGH31123	3"X1"1/2X3"			
130RGH322	3"X2"X2"			
130RGH323	3"X2"X3"			
130RGH32123	3"X2"1/2X3"			
130RGH332	3"X3"X2"			
130RGH414	4"X1"X4"			
130RGH41124	4"X1"1/2X4"			

RACCORDI IN GHISA MALLEABILE ZINCATA -CUORE BIANCO- EN10242

CODICE	Ø MISURA	TEE A UNA CURVA	FIG.131	PREZZO €
131GH12	1/2"			
131GH34	3/4"			
131GH1	1"			
131GH114	1"1/4			
131GH112	1"1/2			
131GH2	2"			
131GH212	2"1/2			
131GH3	3"			
131GH4	4"			



CODICE	Ø MISURA	TEE A DUE CURVE	FIG.132	PREZZO €
132GH12	1/2"			
132GH34	3/4"			
132GH1	1"			
132GH114	1"1/4			
132GH112	1"1/2			
132GH2	2"			
132GH212	2"1/2			
132GH3	3"			



CODICE	Ø MISURA	TEE MASCHIO FF	FIG.134	PREZZO €
134GH14	1/4"			
134GH38	3/8"			
134GH12	1/2"			
134GH34	3/4"			
134GH1	1"			
134GH114	1"1/4			
134GH112	1"1/2			
134GH2	2"			



CODICE	Ø MISURA	TEE A 45°	FIG.165	PREZZO €
165GH12	1/2"			
165GH34	3/4"			
165GH1	1"			
165GH114	1"1/4			
165GH112	1"1/2			
165GH2	2"			



RACCORDI IN GHISA MALLEABILE ZINCATA -CUORE BIANCO- EN10242

CODICE	Ø MISURA	CROCE	FIG.180	PREZZO €
180GH14	1/4"			
180GH38	3/8"			
180GH12	1/2"			
180GH34	3/4"			
180GH1	1"			
180GH114	1"1/4			
180GH112	1"1/2			
180GH2	2"			
180GH212	2"1/2			
180GH3	3"			
180GH4	4"			



CODICE	Ø MISURA	DISTRIBUZIONE A GOMITO	FIG.221	PREZZO €
221GH38	3/8"			
221GH12	1/2"			
221GH34	3/4"			
221GH1	1"			
221GH114	1"1/4			
221GH112	1"1/2			
221GH2	2"			



CODICE	Ø MISURA	DISTRIBUZIONE A TEE	FIG.223	PREZZO €
223GH12	1/2"			
223GH34	3/4"			
223GH1	1"			
223GH114	1"1/4			
223GH112	1"1/2			
223GH2	2"			



CODICE	Ø MISURA	MANICOTTO RIDOTTO FF	FIG.240	PREZZO €
240GH1418	1/4" X 1/8"			
240GH3818	3/8" X 1/8"			
240GH3814	3/8" X 1/4"			
240GH1214	1/2" X 1/4"			
240GH1238	1/2" X 3/8"			
240GH3414	3/4" X 1/4"			
240GH3438	3/4" X 3/8"			
240GH3412	3/4" X 1/2"			
240GH114	1" X 1/4"			
240GH138	1" X 3/8"			
240GH112	1" X 1/2"			
240GH134	1" X 3/4"			
240GH11438	1"1/4 X 3/8"			
240GH11412	1"1/4 X 1/2"			
240GH11434	1"1/4 X 3/4"			
240GH1141	1"1/4 X 1"			
240GH11212	1"1/2 X 1/2"			
240GH11234	1"1/2 X 3/4"			
240GH1121	1"1/2 X 1"			



RACCORDI IN GHISA MALLEABILE ZINCATA -CUORE BIANCO- EN10242

CODICE	Ø MISURA	MANICOTTO RIDOTTO FF	FIG.240	PREZZO €
240GH112114	1"1/2 X 1"1/4			
240GH212	2" X 1/2"			
240GH234	2" X 3/4"			
240GH21	2" X 1"			
240GH2114	2" X 1"1/4			
240GH2112	2" X 1"1/2			
240GH21212	2"1/2 X 1/2"			
240GH2121	2"1/2 X 1"			
240GH212114	2"1/2 X 1"1/4			
240GH212112	2"1/2 X 1"1/2			
240GH2122	2"1/2 X 2"			
240GH31	3" X 1"			
240GH3114	3" X 1"1/4			
240GH3112	3" X 1"1/2			
240GH32	3" X 2"			
240GH3212	3" X 2"1/2			
240GH4112	4" X 1"1/2			
240GH42	4" X 2"			
240GH4212	4" X 2"1/2			
240GH43	4" X 3"			
240GH63	6" X 3"			
240GH64	6" X 4"			
240GH65	6" X 5"			



CODICE	Ø MISURA	NIPPLO DI RIDUZIONE MF	FIG.241	PREZZO €
241GH1418	1/4"X1/8"			
241GH3818	3/8" X 1/8"			
241GH3814	3/8" X 1/4"			
241GH1218	1/2" X 1/8"			
241GH1214	1/2" X 1/4"			
241GH1238	1/2" X 3/8"			
241GH3414	3/4" X 1/4"			
241GH3438	3/4" X 3/8"			
241GH3412	3/4" X 1/2"			
241GH114	1" X 1/4"			
241GH138	1" X 3/8"			
241GH112	1" X 1/2			
241GH134	1" X 3/4"			
241GH11414	1"1/4 X 1/4"			
241GH11438	1"1/4 X 3/8"			
241GH11412	1"1/4 X 1/2"			
241GH11434	1"1/4 X 3/4"			
241GH1141	1"1/4 X 1"			
241GH11214	1"1/2 X 1/4"			
241GH11238	1"1/2 X 3/8"			
241GH11212	1"1/2 X 1/2"			
241GH11234	1"1/2 X 3/4"			
241GH1121	1"1/2 X 1"			
241GH112114	1"1/2 X 1"1/4			
241GH238	2" X 3/8"			
241GH212	2 X "1/2"			
241GH234	2" X 3/4"			
241GH21	2" X 1"			
241GH2114	2" X 1"1/4			
241GH2112	2" X 1"1/2			
241GH21212	2"1/2 X 1/2"			
241GH21234	2"1/2 X 3/4"			



RACCORDI IN GHISA MALLEABILE ZINCATA -CUORE BIANCO- EN10242

CODICE	Ø MISURA	NIPPOLO DI RIDUZIONE MF	FIG.241	PREZZO €
241GH2121	2"1/2 X 1"			
241GH212114	2"1/2 X 1"1/4			
241GH212112	2"1/2 X 1"1/2			
241GH2122	2"1/2 X 2"			
241GH312	3" X 1/2"			
241GH334	3" X 3/4"			
241GH31	3" X 1"			
241GH3114	3" X 1"1/4			
241GH3112	3" X 1"1/2			
241GH32	3" X 2"			
241GH3212	3" X 2"1/2			
241GH41	4" X 1"			
241GH4114	4" X 1"1/4			
241GH4112	4" X 1"1/2			
241GH42	4" X 2"			
241GH4212	4" X 2"1/2			
241GH43	4" X 3"			
241GH54	5" X 4"			
241GH62	6" X 2"			
241GH63	6" X 3"			
241GH64	6" X 4"			



CODICE	Ø MISURA	NIPPOLO DOPPIO DI RIDUZIONE	FIG.245	PREZZO €
245GH1418	1/4"X1/8"			
245GH3818	3/8" X 1/8"			
245GH3814	3/8" X 1/4"			
245GH1214	1/2" X 1/4"			
245GH1238	1/2" X 3/8"			
245GH3414	3/4" X 1/4"			
245GH3438	3/4" X 3/8"			
245GH3412	3/4" X 1/2"			
245GH138	1" X 3/8"			
245GH112	1" X 1/2"			
245GH134	1" X 3/4"			
245GH11412	1"1/4 X 1/2"			
245GH11434	1"1/4 X 3/4"			
245GH1141	1"1/4 X 1"			
245GH11212	1"1/2 X 1/2"			
245GH11234	1"1/2 X 3/4"			
245GH1121	1"1/2 X 1"			
245GH112114	1"1/2 X 1"1/4			
245GH212	2" X 1/2"			
245GH234	2" X 3/4"			
245GH21	2" X 1"			
245GH2114	2" X 1"1/4			
245GH2112	2" X 1"1/2			
245GH2121	2"1/2 X 1"			
245GH212114	2"1/2 X 1"1/4			
245GH212112	2"1/2 X 1"1/2			
245GH2122	2"1/2 X 2"			
245GH32	3" X 2"			
245GH3212	3" X 2"1/2			
245GH4212	4" X 2"1/2			
245GH43	4" X 3"			



RACCORDI IN GHISA MALLEABILE ZINCATA -CUORE BIANCO- EN10242

CODICE	Ø MISURA	MANICOTTO RIDOTTO MF	FIG.246	PREZZO €
246GH1418	1/4"X1/8"			
246GH3814	3/8" X 1/4"			
246GH1214	1/2" X 1/4"			
246GH1238	1/2" X 3/8"			
246GH3438	3/4" X 3/8"			
246GH3412	3/4" X 1/2"			
246GH112	1" X 1/2"			
246GH134	1" X 3/4"			
246GH11412	1"1/4 X 1/2"			
246GH11434	1"1/4 X 3/4"			
246GH1141	1"1/4 X 1"			
246GH11234	1"1/2 X 3/4"			
246GH1121	1"1/2 X 1"			
246GH112114	1"1/2 X 1"1/4"			
246GH21	2" X 1"			
246GH2114	2" X 1"1/4"			
246GH2112	2" X 1"1/2"			
246GH212112	2"1/2 X 1"1/2"			
246GH2122	2"1/2 X 2"			
246GH32	3" X 2"			
246GH3212	3" X 2"1/2"			



CODICE	Ø MISURA	MANICOTTO FF	FIG.270	PREZZO €
270GH18	1/8"			
270GH14	1/4"			
270GH38	3/8"			
270GH12	1/2"			
270GH34	3/4"			
270GH1	1"			
270GH114	1"1/4"			
270GH112	1"1/2"			
270GH2	2"			
270GH212	2"1/2"			
270GH3	3"			
270GH4	4"			
270GH5	5"			
270GH6	6"			



CODICE	Ø MISURA	MANICOTTO DESTRO SINISTRO	FIG.271	PREZZO €
271GH38	3/8"			
271GH12	1/2"			
271GH34	3/4"			
271GH1	1"			
271GH114	1"1/4"			
271GH112	1"1/2"			
271GH2	2"			



RACCORDI IN GHISA MALLEABILE ZINCATA -CUORE BIANCO- EN10242

CODICE	Ø MISURA	NIPPLO DOPPIO	FIG.280	PREZZO €
280GH18	1/8"			
280GH14	1/4"			
280GH38	3/8"			
280GH12	1/2"			
280GH34	3/4"			
280GH1	1"			
280GH114	1"1/4			
280GH112	1"1/2			
280GH2	2"			
280GH212	2"1/2			
280GH3	3"			
280GH4	4"			
280GH5	5"			
280GH6	6"			



CODICE	Ø MISURA	NIPPLO DOPPIO DX/SX	FIG.281	PREZZO €
281GH38	3/8"			
281GH12	1/2"			
281GH34	3/4"			
281GH1	1"			
281GH114	1"1/4			
281GH112	1"1/2			
281GH2	2"			



CODICE	Ø MISURA	TAPPO MASCHIO	FIG.290	PREZZO €
290GH18	1/8"			
290GH14	1/4"			
290GH38	3/8"			
290GH12	1/2"			
290GH34	3/4"			
290GH1	1"			
290GH114	1"1/4			
290GH112	1"1/2			
290GH2	2"			
290GH212	2"1/2			
290GH3	3"			
290GH4	4"			
290GH5	5"			
290GH6	6"			



CODICE	Ø MISURA	TAPPO FEMMINA	FIG.300	PREZZO €
300GH18	1/8"			
300GH14	1/4"			
300GH38	3/8"			
300GH12	1/2"			
300GH34	3/4"			
300GH1	1"			
300GH114	1"1/4			
300GH112	1"1/2			
300GH2	2"			
300GH212	2"1/2			
300GH3	3"			
300GH4	4"			



RACCORDI IN GHISA MALLEABILE ZINCATA -CUORE BIANCO- EN10242

CODICE	Ø MISURA	TAPPO FEMMINA TONDO	FIG.301	PREZZO €
301GH14	1/4"			
301GH38	3/8"			
301GH12	1/2"			
301GH34	3/4"			
301GH1	1"			
301GH114	1"1/4			
301GH112	1"1/2			
301GH2	2"			
301GH212	2"1/2			
301GH3	3"			
301GH4	4"			



CODICE	Ø MISURA	CONTRODADO	FIG.310	PREZZO €
310GH18	1/8"			
310GH14	1/4"			
310GH38	3/8"			
310GH12	1/2"			
310GH34	3/4"			
310GH1	1"			
310GH114	1"1/4			
310GH112	1"1/2			
310GH2	2"			
310GH212	2"1/2			
310GH3	3"			
310GH4	4"			



CODICE	Ø MISURA	BOCCHETTONE PIANO FF	FIG.330	PREZZO €
330GH14	1/4"			
330GH38	3/8"			
330GH12	1/2"			
330GH34	3/4"			
330GH1	1"			
330GH114	1"1/4			
330GH112	1"1/2			
330GH2	2"			
330GH212	2"1/2			
330GH3	3"			
330GH4	4"			



CODICE	Ø MISURA	BOCCHETTONE PIANO MF	FIG.331	PREZZO €
331GH14	1/4"			
331GH38	3/8"			
331GH12	1/2"			
331GH34	3/4"			
331GH1	1"			
331GH114	1"1/4			
331GH112	1"1/2			
331GH2	2"			
331GH212	2"1/2			
331GH3	3"			
331GH4	4"			



RACCORDI IN GHISA MALLEABILE ZINCATA -CUORE BIANCO- EN10242

CODICE	Ø MISURA	BOCCHETTONE CONICO FF	FIG.340	PREZZO €
340GH18	1/8"			
340GH14	1/4"			
340GH38	3/8"			
340GH12	1/2"			
340GH34	3/4"			
340GH1	1"			
340GH114	1"1/4			
340GH112	1"1/2			
340GH2	2"			
340GH212	2"1/2			
340GH3	3"			
340GH4	4"			



CODICE	Ø MISURA	BOCCHETTONE CONICO MF	FIG.341	PREZZO €
341GH14	1/4"			
341GH38	3/8"			
341GH12	1/2"			
341GH34	3/4"			
341GH1	1"			
341GH114	1"1/4			
341GH112	1"1/2			
341GH2	2"			
341GH212	2"1/2			
341GH3	3"			
341GH4	4"			



CODICE	Ø MISURA	PEZZI FOLLI PIANI	FIG.372	PREZZO €
372GH12	1/2"			
372GH34	3/4"			
372GH1	1"			
372GH114	1"1/4			
372GH112	1"1/2			
372GH2	2"			



CODICE	Ø MISURA	DADO PER BOCCHETTONE	FIG.374	PREZZO €
374GH12	1/2"			
374GH34	3/4"			
374GH1	1"			
374GH114	1"1/4			
374GH112	1"1/2			
374GH2	2"			



RACCORDI IN GHISA MALLEABILE ZINCATA -CUORE BIANCO- EN10242

CODICE	Ø MISURA	GOMITO PER PARETE	FIG.471	PREZZO €
471GH12	1/2"			
471GH34	3/4"			



CODICE	Ø MISURA	MANICOTTO MF	FIG.529	PREZZO €
529GH14	1/4"			
529GH38	3/8"			
529GH12	1/2"			
529GH34	3/4"			
529GH1	1"			
529GH114	1"1/4			
529GH112	1"1/2			
529GH2	2"			



CODICE	Ø MISURA	NIPPLO PER TUBO IN PLASTICA	FIG.900	PREZZO €
900GH12	1/2"			
900GH34	3/4"			
900GH1	1"			
900GH114	1"1/4			
900GH112	1"1/2			
900GH2	2"			



Riduzioni Flangiate

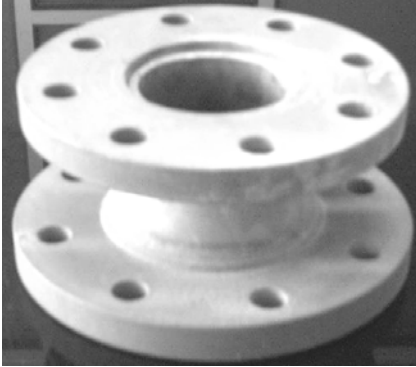

Particolare composto da flangie pn 16 e riduzioni
en 10253-1

In esecuzione dal dn 40 al dn 300

Distributore a tre vie



Particolare costruito a disegno dalla nostra azienda
per un importante opera di irrigazione

Tee Uguali e Ridotti Flangiati

In esecuzione dal dn 50 al dn 300

Settore Industriale - Nautico

2016

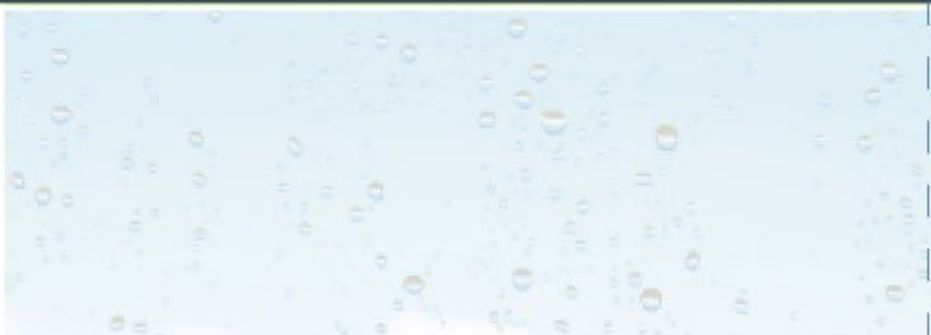



F.I.M.

Forniture Industriali Meridionali s.r.l.

Via Delle Magnolie 10/E-10/F
70026-MODUGNO (Ba)
Tel. Mag. 080.9904402
Tel.Comm. 080.9904312
Fax. 080.9904403

www.fimbari.it
info@fimbari.it